

AXCENT INSTALLATION SHEET

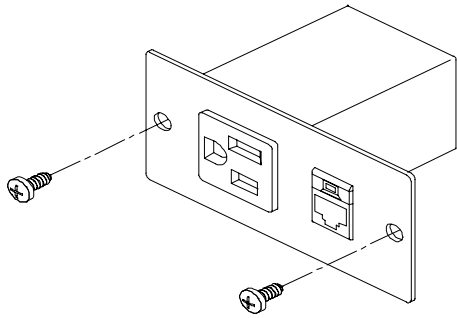

Axcent 3 & 4
Place into appropriate cutout and attach with screws as shown (not provided).

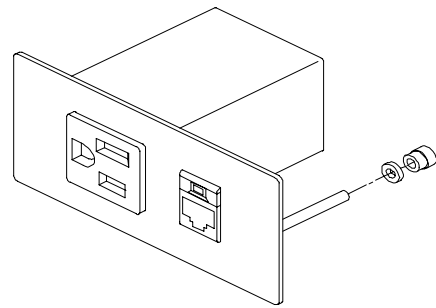

Axcent 1 & 2
Place into appropriate cutout and attach with washers & thumb nuts as shown.

Max Radius at Corners = 1/8"

Diagram 2
Cutout for
Axcent 1 & 3

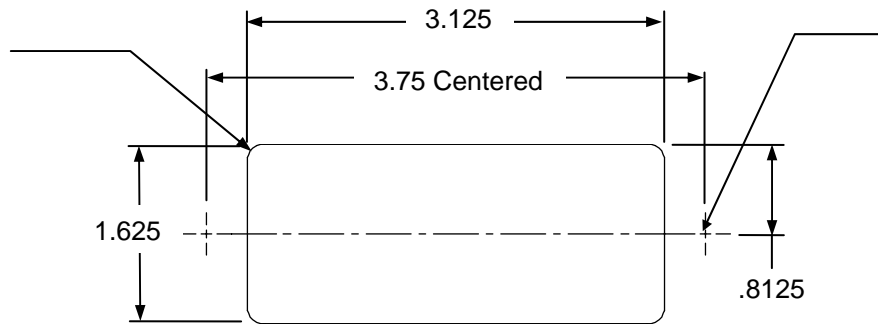

Axcent 1 – 1/4" Hole
Axcent 3 – Pilot Hole
Typical 2

Diagram 3
Cutout for
Axcent 2 & 4

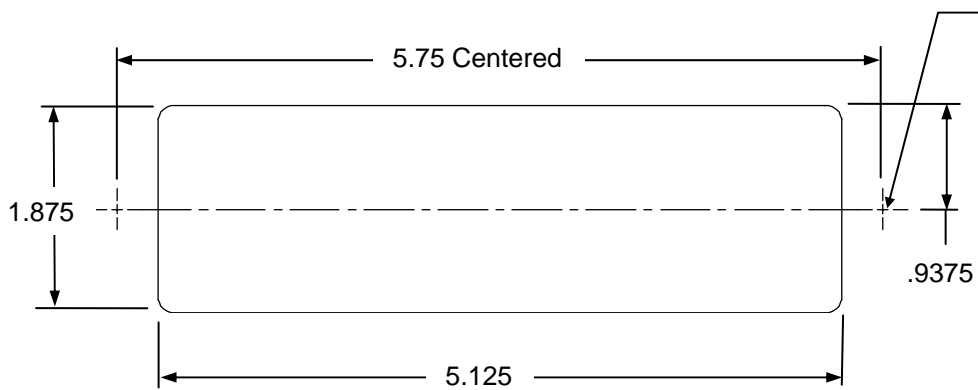

Axcent 2 – 1/4" Hole
Axcent 4 – Pilot Hole
Typical 2

Axcent Installation

1. Cutout the surface to the size needed dependent on your application. See diagram 2 & 3.
2. Install Axcent into opening. On Axcent 1 & 2 remove plastic thumb nuts and washer first.
3.
 - a. For Axcent 1 & 2 reinstall washer & plastic thumb nuts and tighten until Axcent is secure.
 - b. For Axcent 3 & 4 attach Axcent to surface with screws (not provided).
4. Connect power and patch cord as needed.

CONCEPT INSTALLATION SHEET

Round Application

Step 1

Determine type of application and ensure table and top sizes fall within the parameters

Step 2

Fabricate top and cutout table as required. Ensure to allow for an adequate clearance between both finished surfaces. Recommended gap is between 1/16" to 1/8".

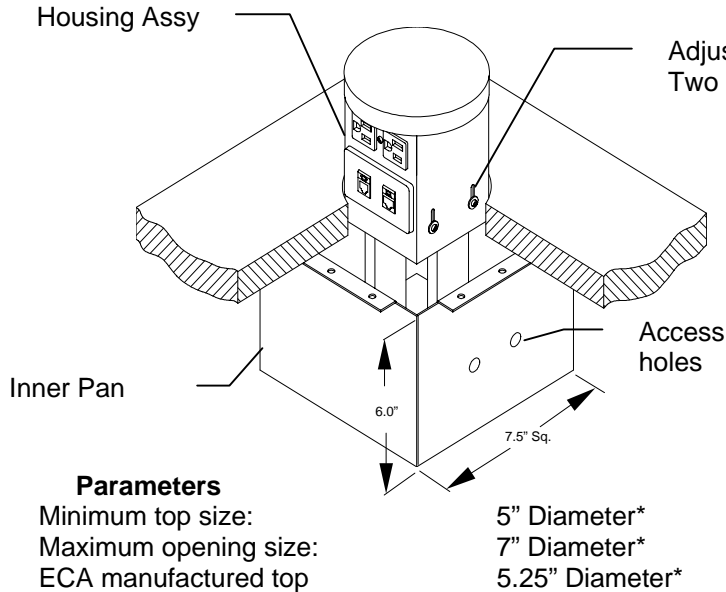

Adjustment screws
Two each side

Step 4 ADJUSTMENTS

To adjust for vertical: loosen the 4 screws on the side of the housing and move housing to the desired position. Holes in Inner Pan may assist in access to screws. Tighten screws.

To center top in opening: loosen 8 adjustment screws and center top in opening and tighten all 8 screws.

Square Application

Step 3

Mount top onto Concept (if required) and mount Concept under table as shown using #10 x 1/2 screws provided (ensure mounting screws don't penetrate table surface. Operate Concept to ensure no interference between top and table occurs and Concept functions properly.

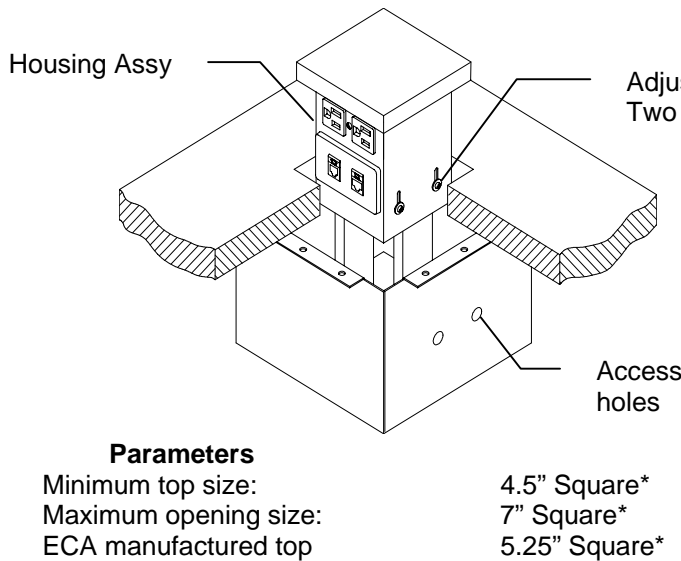

Adjustment screws
Two each side

Step 5

Feed Tel/Com wiring up through wire loop on leg and through grommet at base of Concept. Hook up Tel/Com jacks and snap plates in place as shown. If Outer Pan is used, feed wires through opening at bottom before loop in leg.

Mount Outer Pan to Concept with screws provided. Plug in Concept

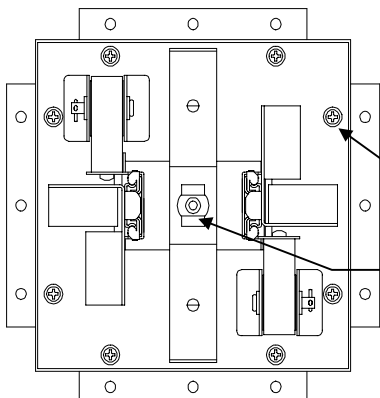

* When using ECA's manufactured tops or trim rings refer to those installation instructions for proper cutout sizes

Adjustment screws
Qty 8

No wires through center hole

Note:

Ensure all adjustment screws are tight and wires are not going to be damaged during operation prior to use.

Concept is now ready for use.

UNDERSIDE OF CONCEPT

9065-0015 Rev F

ELECTRI-CABLE ASSEMBLIES
 Tel: 203.924.6617 Fax: 203.924.6687
 www.electri-cable.com

CONCEPT TABLE REQUIREMENTS

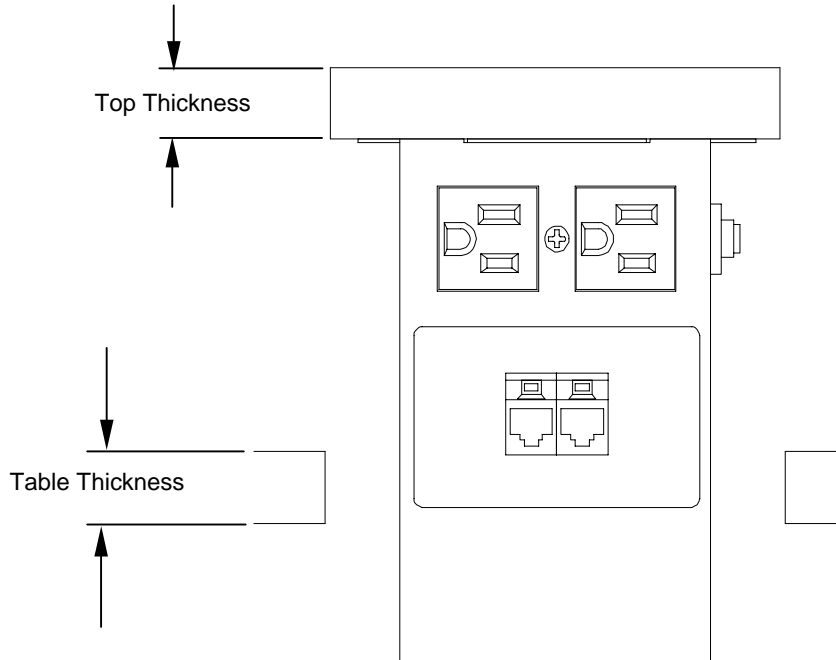

It is very important that the Concept top thickness is the correct thickness or access to the data ports will be restricted.

Determining Recommended Top Thickness

1. Using the chart to the right find the table thickness on the bottom scale.
2. Move up the chart until you reach the first line, this is the minimum the top thickness can be.
3. Move further up the chart until you reach the next, solid, line. This is the maximum thickness the top can be.
4. Your finished top should fall between these two limits, for most cases it will be between 1/8" – 3/4".
5. The upper, dotted, line represents the maximum thickness for the top if no data connections are needed.

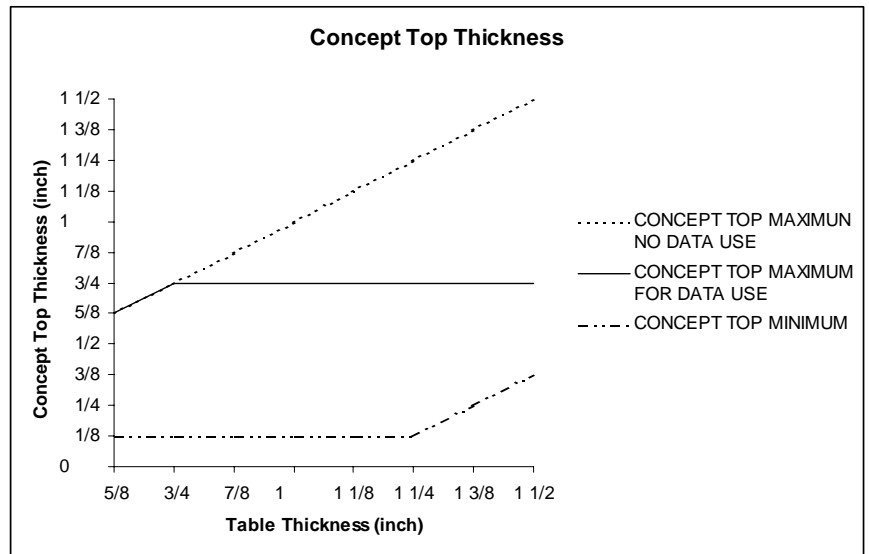

Note: If one of ECA's decorative metal plates are to be used as the Concept top the following needs to be considered.

1. The plate thickness is 1/8"
2. The maximum table thickness is 1-1/4".

DATA PORTAL INSTALLATION SHEET

Table Cutout Size
2-3/16 x 2-13/16
(Fits surface thickness from 3/4" to 1-1/2")

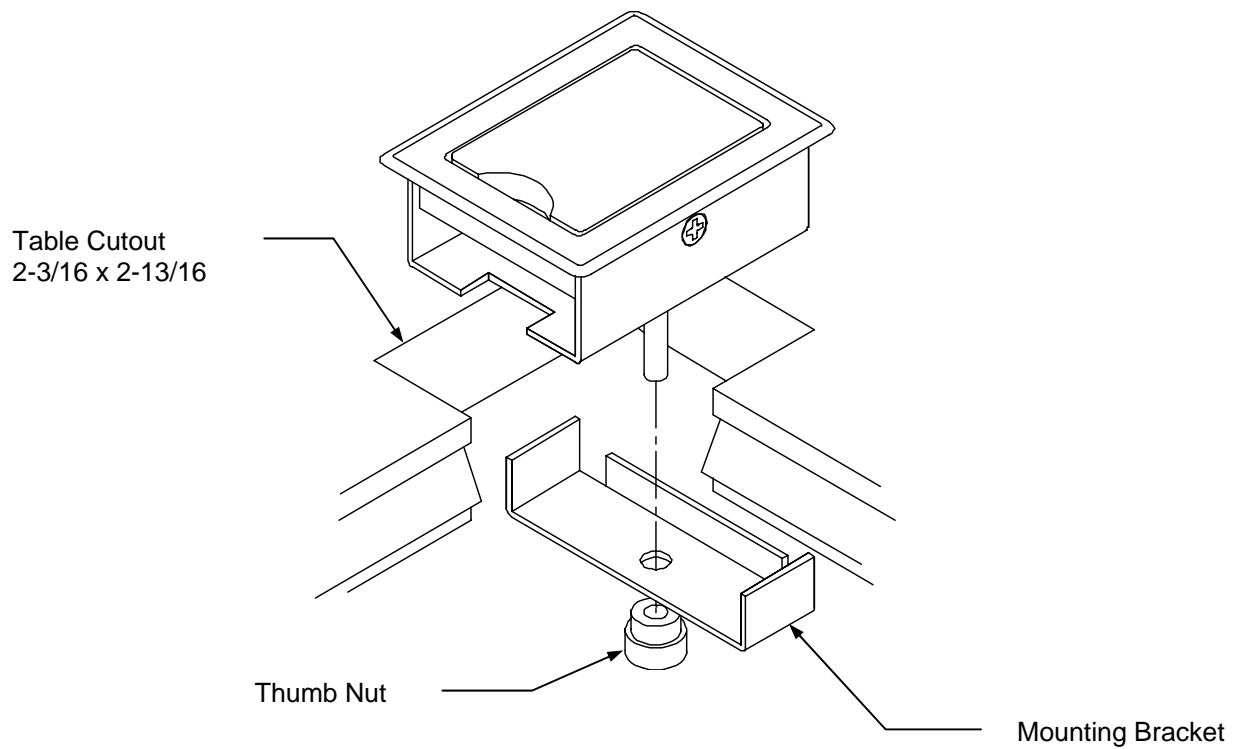

Installation

1. Remove mounting bracket from Data Portal by removing plastic thumb nut.
2. Install Data Portal into table cutout as shown and reinstall mounting bracket and plastic thumb nut and tighten as required.
3. Connect data jack as needed

FLUSH DATA BOX INSTALLATION SHEET

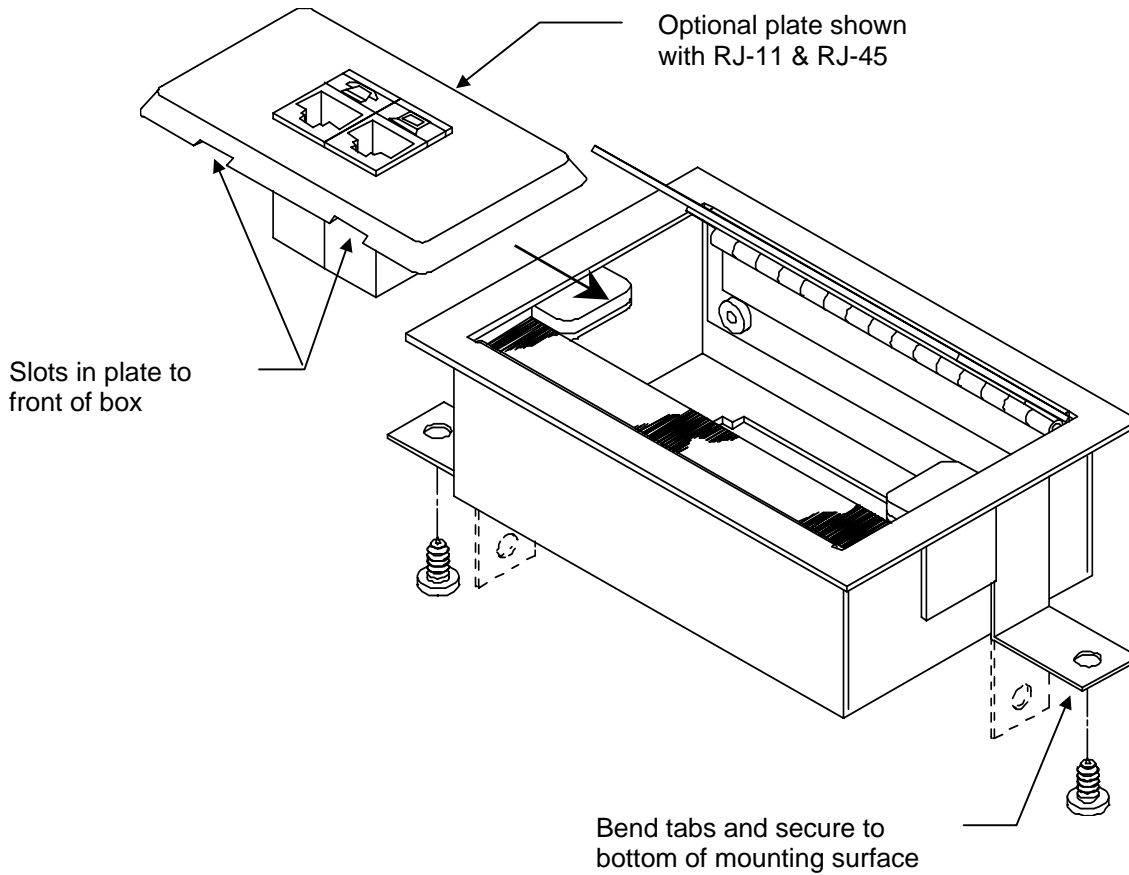

Flush Data Box Installation

1. Cutout surface to provide a 4-9/16" X 2-7/8" opening. Surface thickness may vary from 3/4" to 1-3/4".
2. Install Flush Data Box into opening.
3. Bend tabs on bottom of box and secure to bottom of surface with two #10 screws provided as shown.
4. Insert connection plate; ensure slots are to front of box.

GLIDE-AWAY INSTALLATION SHEET

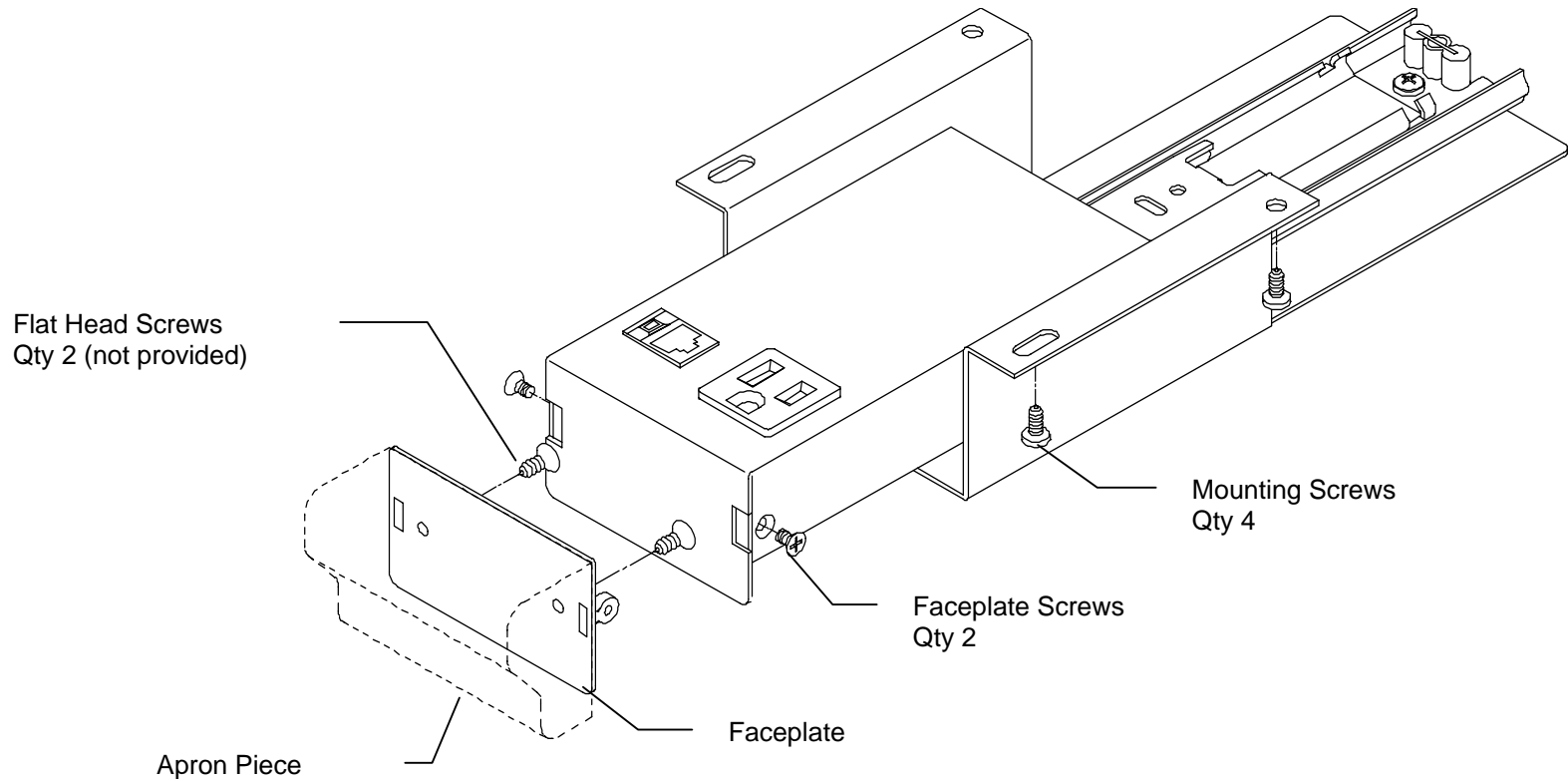

1. Determine position for Glide-Away and cutout notch in apron accordingly (minimum width = 3 $\frac{1}{4}$ ").
2. Center Glide-Away on opening with Faceplate flush with rear of apron and secure to underside of table with screws provided (minimum table thickness = $\frac{3}{4}$ "
Note: Use only 2 front screws at this point to allow for adjustment after Apron Piece is attached).
3. Remove Faceplate by removing Faceplate Screws (retain screws for latter use).
4. Mount Apron Piece to Faceplate using 2 flat head screws (not provided).
5. Remount Faceplate, with Apron Piece attached, using screws from step 3 (use caution not to strip screws).
6. Adjust front of Apron Piece to be flush with remainder of apron and install 2 rear mounting screws (ensure slide is fully retracted before adjusting)
7. Coil or dress wires under table to be sure that no wear will occur during operation.
8. Test Glide-Away for smooth operation.

INTERACT INSTALLATION SHEET

Cutout table as shown.

Corners may have a maximum of $\frac{1}{4}$ " radius.

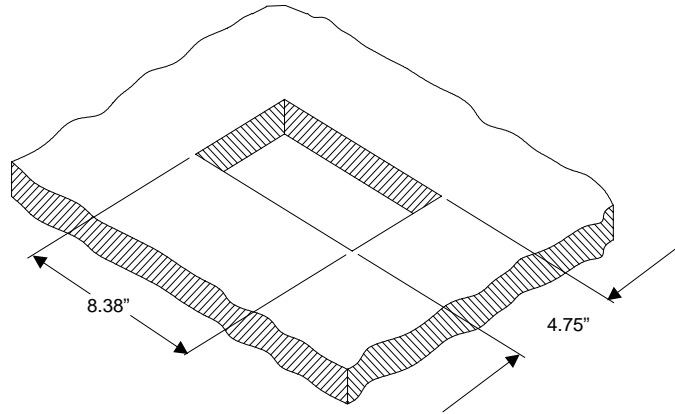

Table Cutout

(Fits surface thickness from $\frac{7}{8}$ " to 2")

Remove mounting bracket by removing plastic nut and washer.

Install Interact into table cutout as needed and reinstall mounting bracket, washer and plastic nut.

Tighten as required.

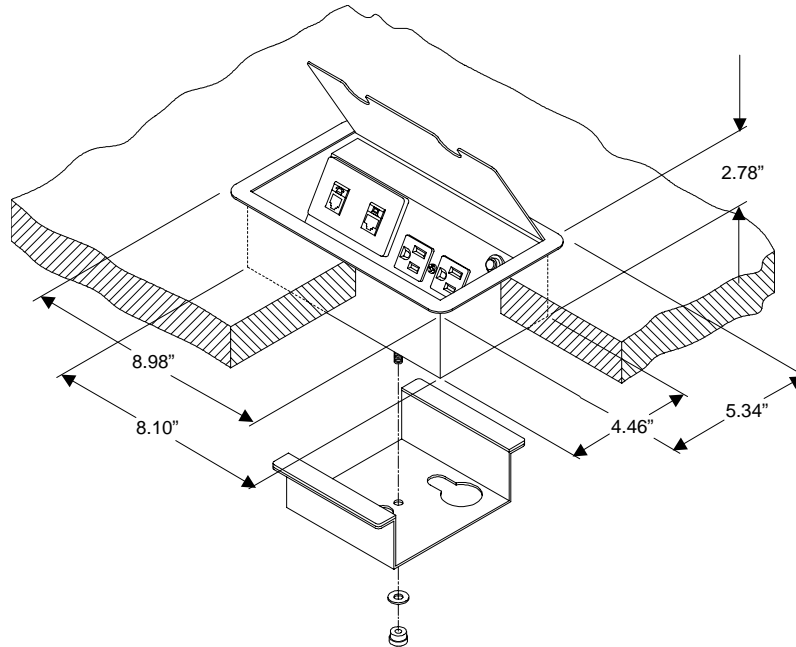

Tel/Com Installation (Optional)

Feed cables up through shutter bushing on underside of Interact and out access window.

Make connections to jacks in plate and snap plate into window.

INTERACT JR. INSTALLATION SHEET

1. Follow the template, Figure 1, for cutout size and bolthole locations.
2. Insert Interact Jr. into cutout and secure with washers and plastic nuts provided, as shown in Figure 2.

NOTE TO TELEPHONE/NETWORK INSTALLER

Some jacks permit installation from the front of the housing. For this feed the cables up through the shutter bushing on the underside of the Interact Jr. and out the clearance holes.

If you require access to the inside of the housing, remove the two screws on the underside of the Interact Jr. This will allow you to lift the housing up and away from the retaining bracket. This will provide access to the inside of the housing. Use caution not to scratch the painted surfaces.

Figure 1

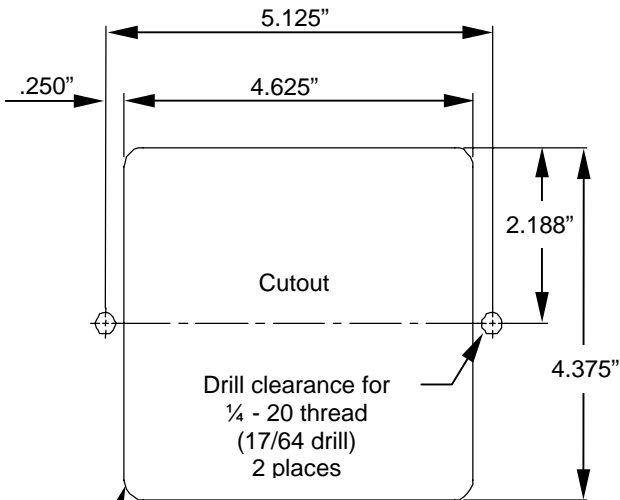
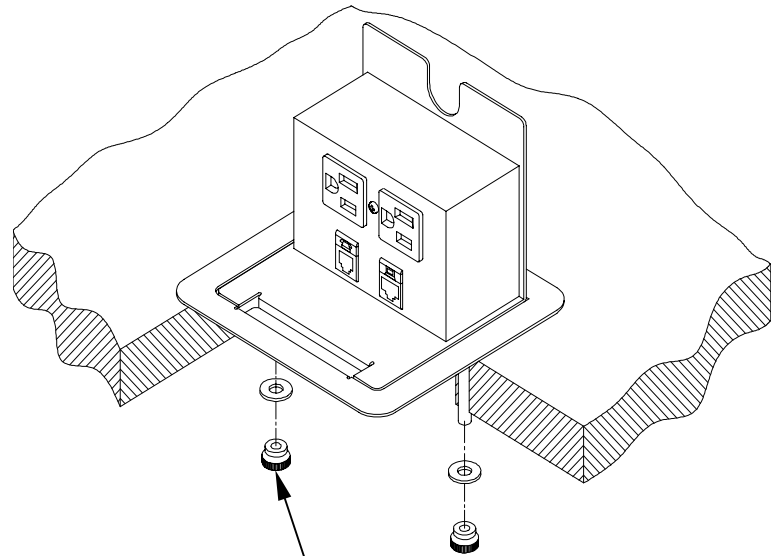

Table Cutout

(Fits surface thickness up to 1.25")

R .250
4 places

Figure 2



IMPORTANT
Do not over tighten nuts.
This may cause the bezel to deform.

INTERACT UT INSTALLATION SHEET

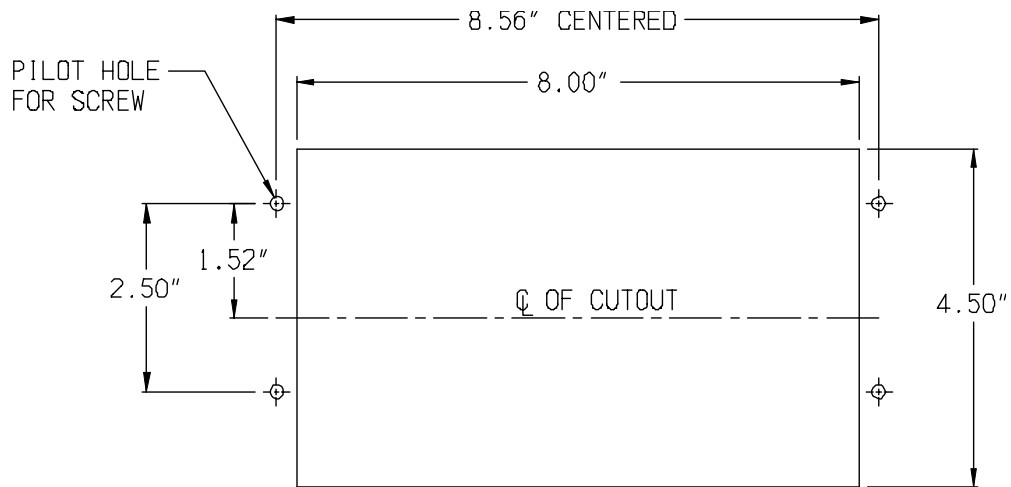

Recommended Table Cutout

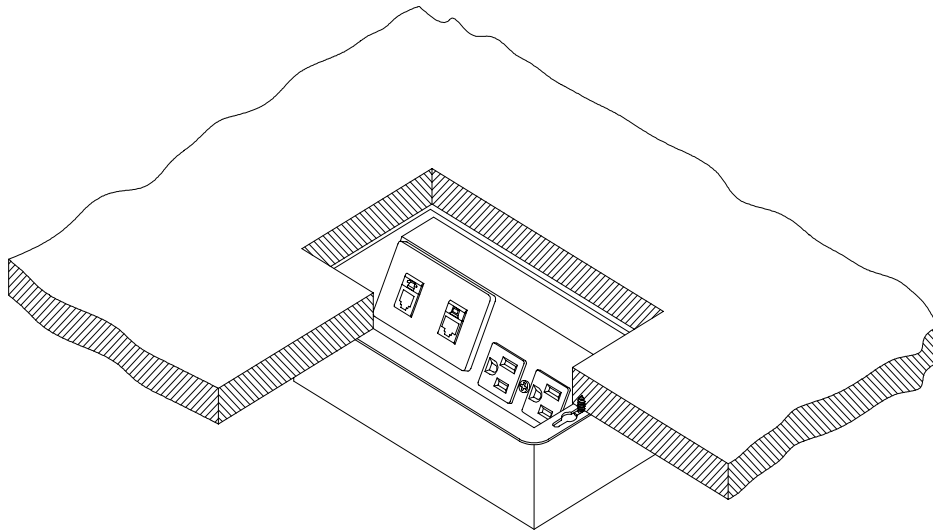

Interact Installation

1. Use Table Cutout above for hole size and screw locations.
2. Mount Interact utilizing keyholes and slide into position.
3. Fabricate top as required.

ComDeck (INTERCEPT 1) INSTALLATION SHEET

NOTE: DO NOT ATTEMPT TO INSTALL THE INTERCEPT PRIOR TO READING THESE INSTRUCTIONS

Step 1. Prepare table per instructions on separate sheet. Be sure to retain portion of cut out tabletop if it will become the finished top of the INTERCEPT 1.

Step 2. Unpack the INTERCEPT 1, being careful not to damage any part, and check to ensure that no items were damaged during shipping. Review parts list to be sure all parts are present.

Step 3. TABLE THICKNESS ADJUSTMENT -The INNER PAN ASSY has four (4) adjustable mounting flanges that can be set for your specific table thickness between .656" - 1.625". The flanges come set for the thinnest table. To change the flanges remove the lock nuts (2 per flange) and move the flanges to the hole that corresponds with the table thickness that the INTERCEPT 1 will be mounted in.

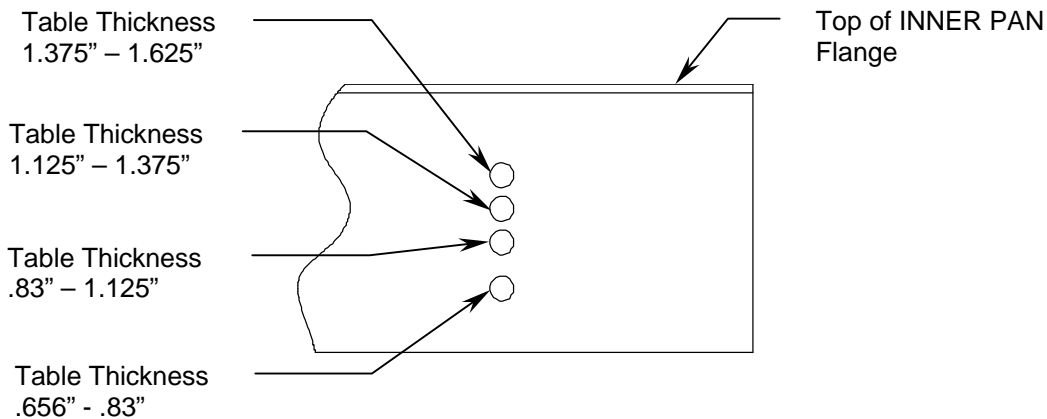

Tighten the lock nuts, be sure all of the flange tops are at the same height.

Step 4. TABLE CUTOUT MOUNTING - Attach CUTOUT PIECE, from table preparation to top of MAIN HOUSING *. The 8 pilot holes should line up. From underside of the INNER PAN, insert screws (use magnetic screwdriver) and secure the CUTOUT PIECE to the MAIN HOUSING.

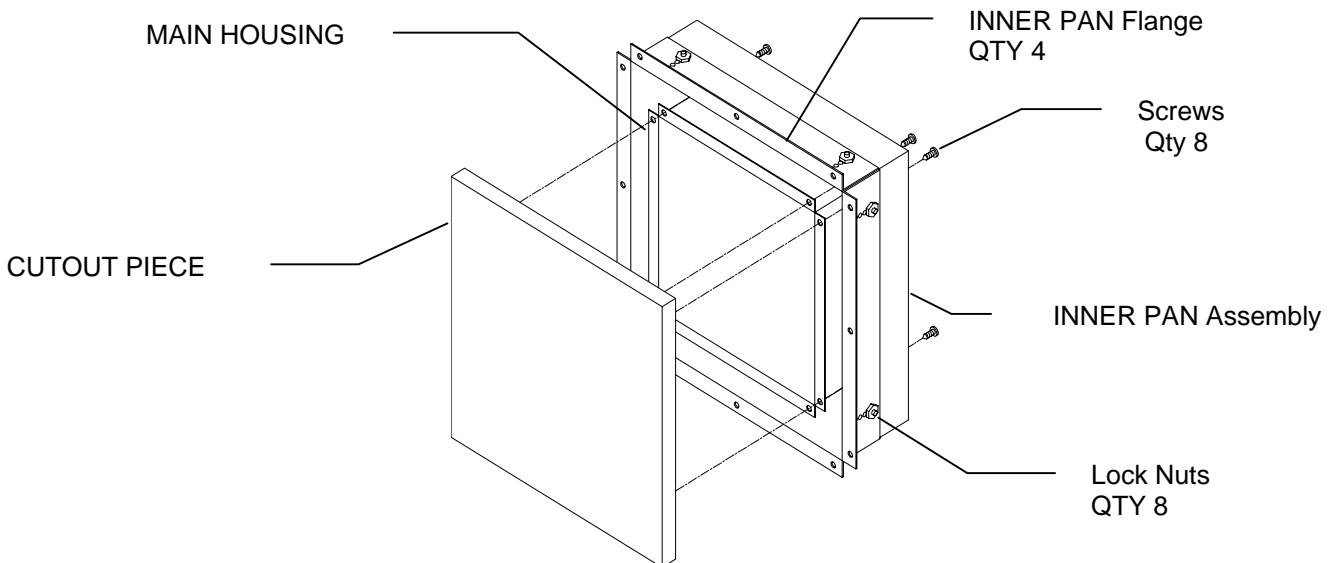

Step 5. INNER PAN MOUNTING - Place the INNER PAN ASSY to the underside of the table and secure with twelve (12) #10 X ½ screws provided, use pilot holes to ensure proper alignment. NOTE: USE CAUTION WHEN POSITIONING THE INTERCEPT 1 ON THE TABLE, ENSURE THAT THE GRAIN OF THE CUTOUT PIECE MATCHES THE TABLE.

#10 X ½ Screws
Qty 12 Included

(If other than included screws are used, be careful not to pierce finish side)

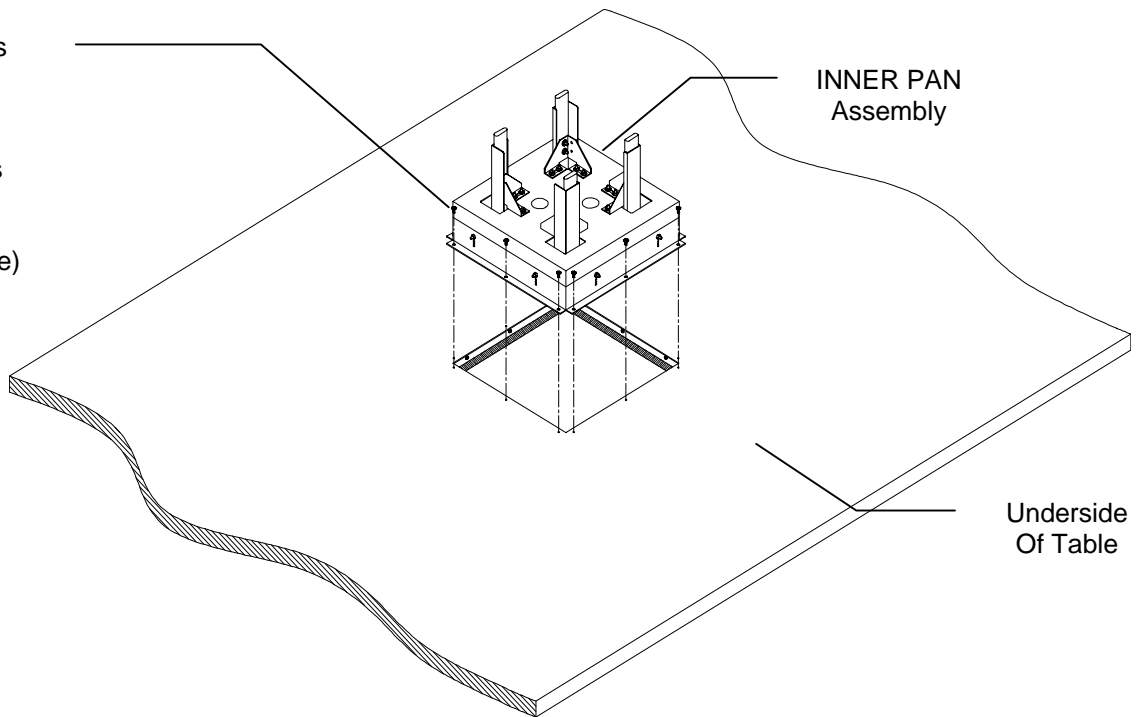

Step 6. OUTER PAN MOUNTING - Position the OUTER PAN below the mounted INNER PAN ASSY. Be sure to feed the power plug through the cutout in the OUTER PAN. Attach the OUTER PAN to the underside of table with six (6) #10 X ½ screws provided. Use pilot holes to ensure proper alignment.

#10 x ½ Screws
Qty 6

(If other than included screws are used, be careful not to pierce finished side)

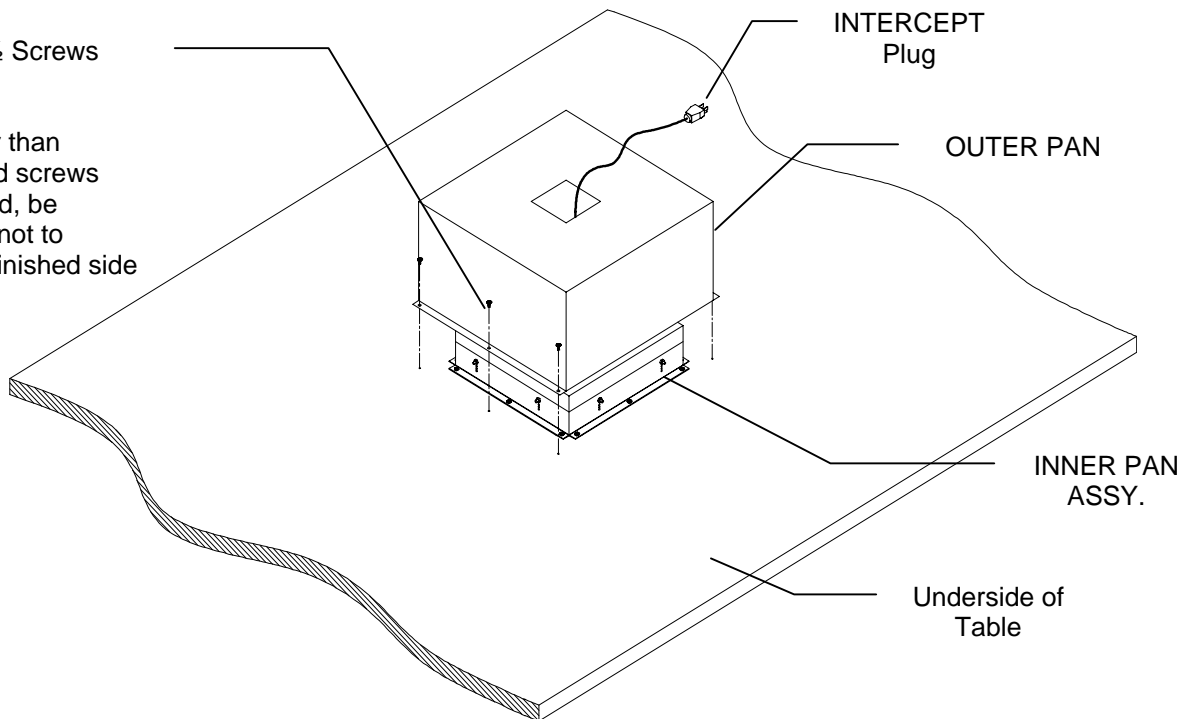

1. OPERATION - To *raise* the INTERCEPT 1, press down on the top of the INTERCEPT 1, in the center and release *. This movement releases the latch and allows the INTERCEPT 1 to raise to the upper limits of the springs. To *lower* the INTERCEPT 1, press the INTERCEPT 1 top, again at the center, downward as far as possible and release (some force is required to overcome the springs and operate the latching mechanism). Plug in the unit and test for proper operation. NOTE: DO NOT USE EXCESSIVE FORCE WHEN OPERATING THE INTERCEPT.

2. VOICE/DATA CONNECTIONS - Raise the INTERCEPT 1, remove the 4 VOICE/DATA Plates, using the special tool provided, and snake the VOICE/DATA wires up through the OUTER PAN and through the 2 SHUTTER BUSHINGS in the bottom of the MAIN HOUSING. Wires should be dressed to move freely up and down with the movement of the MAIN HOUSING. This step can be done before mounting the INTERCEPT 1 however, be sure all wires are run through the cutout in the OUTER PAN before completing step 5.

***Note:** If a CUTOUT PIECE other than the one obtained from the table preparation sheet, i.e. round, is to be used the following conditions need to be considered.

- ◆ The latching mechanism requires a minimum overtravel distance of ¼” to function properly.
- ◆ If the CUTOUT PIECE is larger than 13”, round or square, an interference with the INNER PAN ASSY can be expected. Provisions need to be made for the required overtravel.
- ◆ No modifications to the Intercept should be made. Any modifications, in addition to voiding any warranty, can effect the proper operation of the Intercept.

Congratulations. Enjoy your Intercept 1.

PART LIST

| | |
|---------------------------------|--------|
| Inner Pan Assembly | Qty 1 |
| Outer Pan (optional) | Qty 1 |
| Table Brush | Qty 4 |
| A-Plate Removal Tool | Qty 1 |
| 7/64 Allen Wrench | Qty 1 |
| #10 X ½ Pan Head Screw | Qty 20 |
| #4 X ½ Pan Head Screw | Qty 12 |
| Table Preparation Instructions | Qty 1 |
| Installation Instructions | Qty 1 |
| Housing Adjustment Instructions | Qty 1 |

ComDeck 2 (INTERCEPT 2) INSTALLATION SHEET

NOTE: DO NOT ATTEMPT TO INSTALL THE INTERCEPT PRIOR TO READING THESE INSTRUCTIONS

Step 1. Prepare table per instructions on separate sheet. Be sure to retain portion of cut out tabletop if it will become the finished top of the INTERCEPT 2.

Step 2. Unpack the INTERCEPT 2, being careful not to damage any part, and check to ensure that no items were damaged during shipping. Review parts list (page 3) to be sure all parts are present.

Step 3. TABLE THICKNESS ADJUSTMENT - The INNER PAN ASSY has four (4) adjustable mounting flanges that can be set for your specific table thickness between .656" - 1.625". The flanges come set for the thinnest table. To change the flanges remove the lock nuts (2 per flange) and move the flanges to the hole that corresponds with the table thickness that the INTERCEPT 2 will be mounted in.

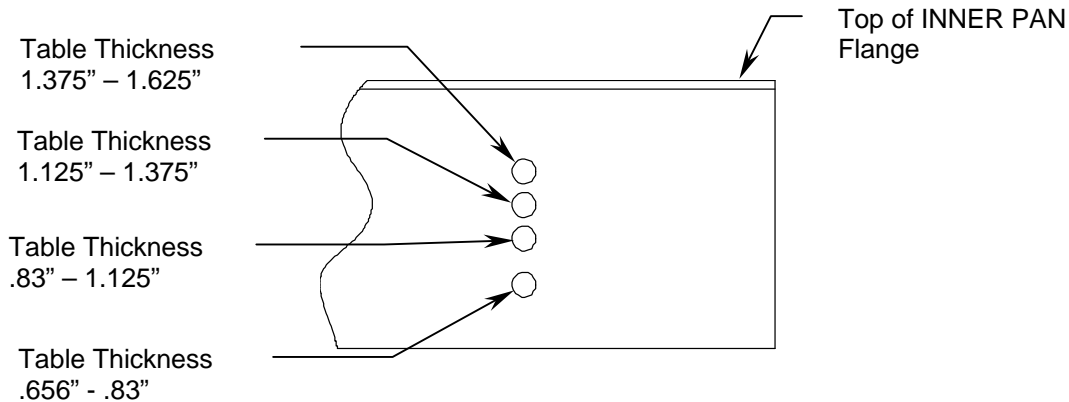

Tighten the lock nuts, be sure all of the flange tops are at the same height

Step 4. TABLE CUTOUT MOUNTING - Attach CUTOUT PIECE, from table preparation, to top of MAIN HOUSING. The 8 pilot holes should line up. From underside of the INNER PAN, insert screws (use magnetic screwdriver) and secure the CUTOUT PIECE to the MAIN HOUSING.

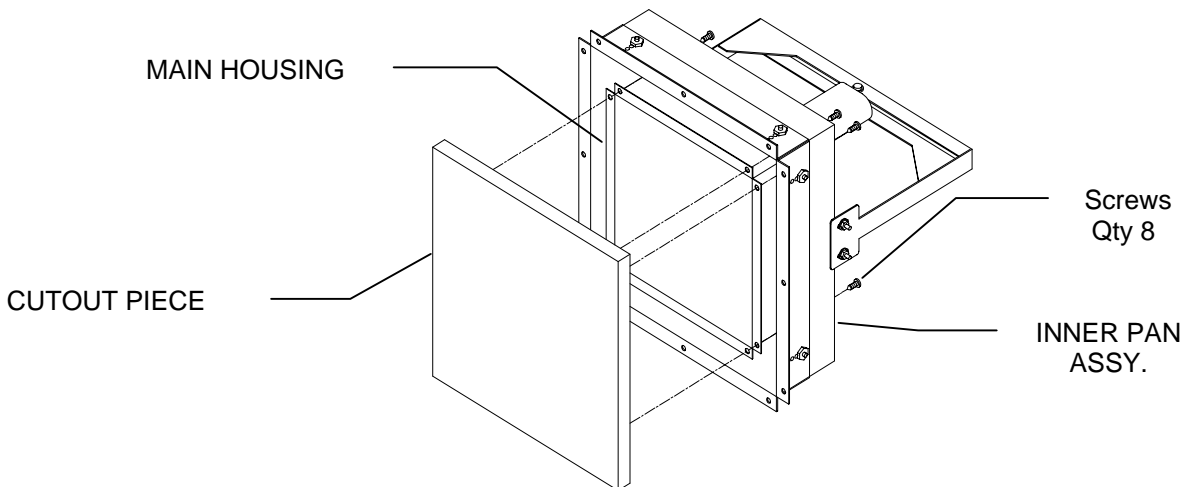

Step 5. INNER PAN MOUNTING - Place the INNER PAN ASSY. to the underside of the table and secure with twelve (12) #10 X ½ screws provided, use pilot holes to ensure proper alignment. NOTE: USE CAUTION WHEN POSITIONING THE INTERCEPT 2 ON THE TABLE, ENSURE THAT THE GRAIN OF THE CUTOUT PIECE MATCHES THE TABLE.

#10 X ½ Screws
Qty 12

(If other than included screws are used, be careful not to pierce finished side)

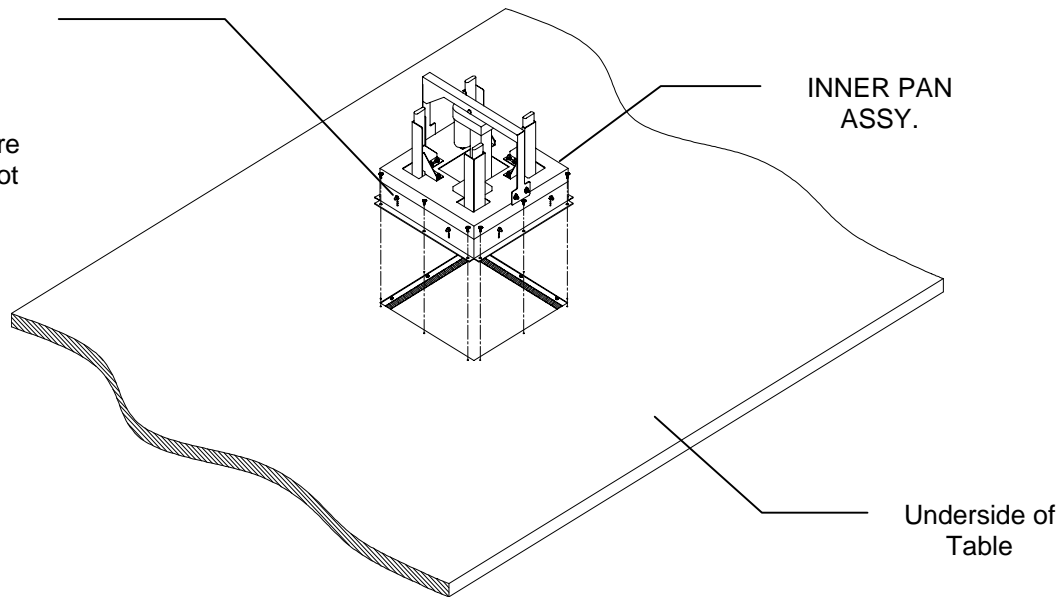

Step 6. OUTER PAN MOUNTING - Position the OUTER PAN ASSY. below the mounted INNER PAN ASSY. Connect the power feed (Twist-Lock), and motor feed wires (RED and BLACK) from the OUTER PAN ASSY to the MAIN HOUSING Twist-Lock and motor. Be sure to feed the wire through the cutout in the OUTER PAN. Attach the OUTER PAN ASSY to the underside of table with six (6) #10 X ½ screws provided. Use pilot holes to ensure proper alignment.

#10 X ½ Screws
Qty 6

(If other than included screws are used, be careful not to pierce finished side)

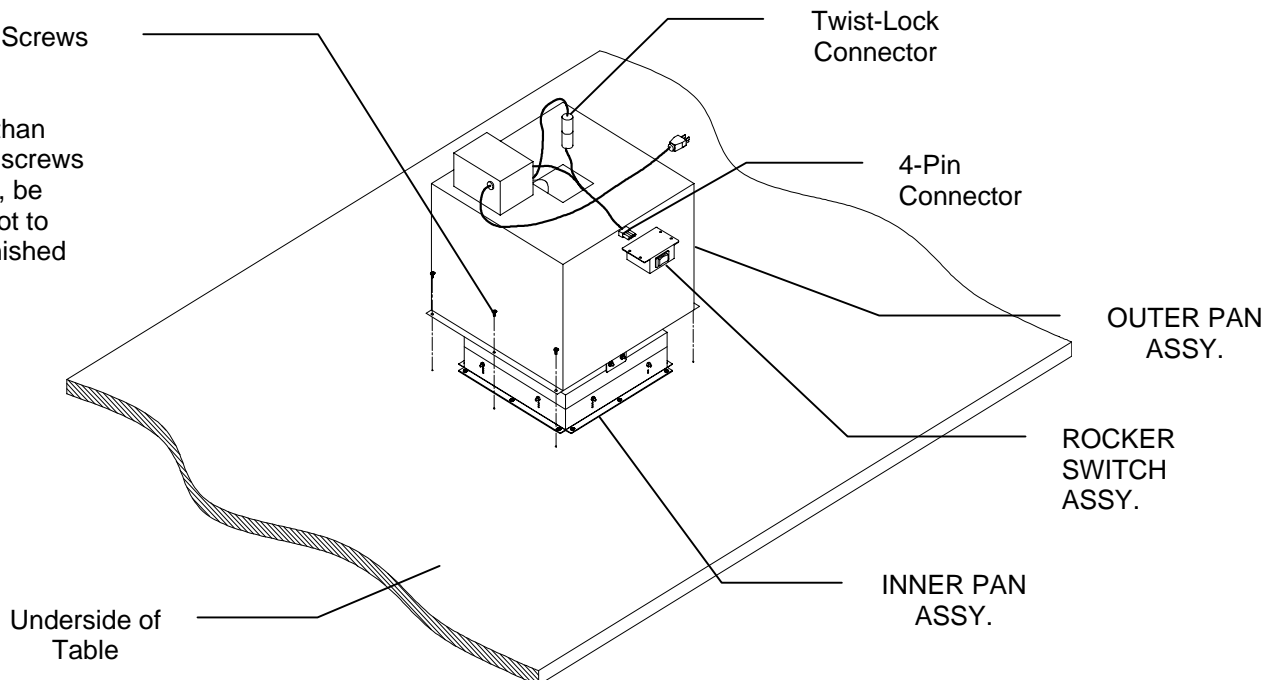

Step 7. Plug the ROCKER SWITCH ASSY onto the cable utilizing the 4-pin connector, plug in the unit and test for proper operation. By pressing the “Raise” side of the ROCKER SWITCH the INTERCEPT 2 should elevate and lock at top. By pressing the “Lower” side of the ROCKER SWITCH the INTERCEPT 2 should return to the original, retracted, position.

If INTERCEPT 2 doesn't operate, check:

1. INTERCEPT 2 is plugged into a powered outlet.
2. Twist-Lock connector between Power Unit and MAIN HOUSING is completely locked into place by twisting.
3. Motor connector is completely latched.

Step 8. ROCKER SWITCH MOUNTING – Mount the ROCKER SWITCH ASSY. in a convenient location using #10 X ½ screws provided. Secure wire as needed.

Step 9. VOICE/DATA CONNECTIONS - Raise the INTERCEPT 2, remove the 4 VOICE/DATA Plates, using the special tool provided, and snake the VOICE/DATA wires up through the OUTER PAN and through the 2 SHUTTER BUSHINGS in the bottom of the MAIN HOUSING. Wires should be dressed to move freely up and down with the movement of the MAIN HOUSING. This step can be done before mounting the INTERCEPT 2 however, be sure all wires are run through the cutout in the OUTER PAN before completing step 5.

Congratulations. Enjoy your Intercept 2.

PART LIST

| | |
|---------------------------------|--------|
| Inner Pan Assembly | Qty 1 |
| Outer Pan Assembly | Qty 1 |
| Rocker Switch Assembly | Qty 1 |
| Table Brush | Qty 4 |
| A-Plate Removal Tool | Qty 1 |
| 7/64 Allen Wrench | Qty 1 |
| #10 X ½ Pan Head Screw | Qty 20 |
| #4 X ½ Pan Head Screw | Qty 12 |
| Table Preparation Instructions | Qty 1 |
| Installation Instructions | Qty 1 |
| Housing Adjustment Instructions | Qty 1 |

INTERFACE I TABLE TOP INSTALLATION SHEET

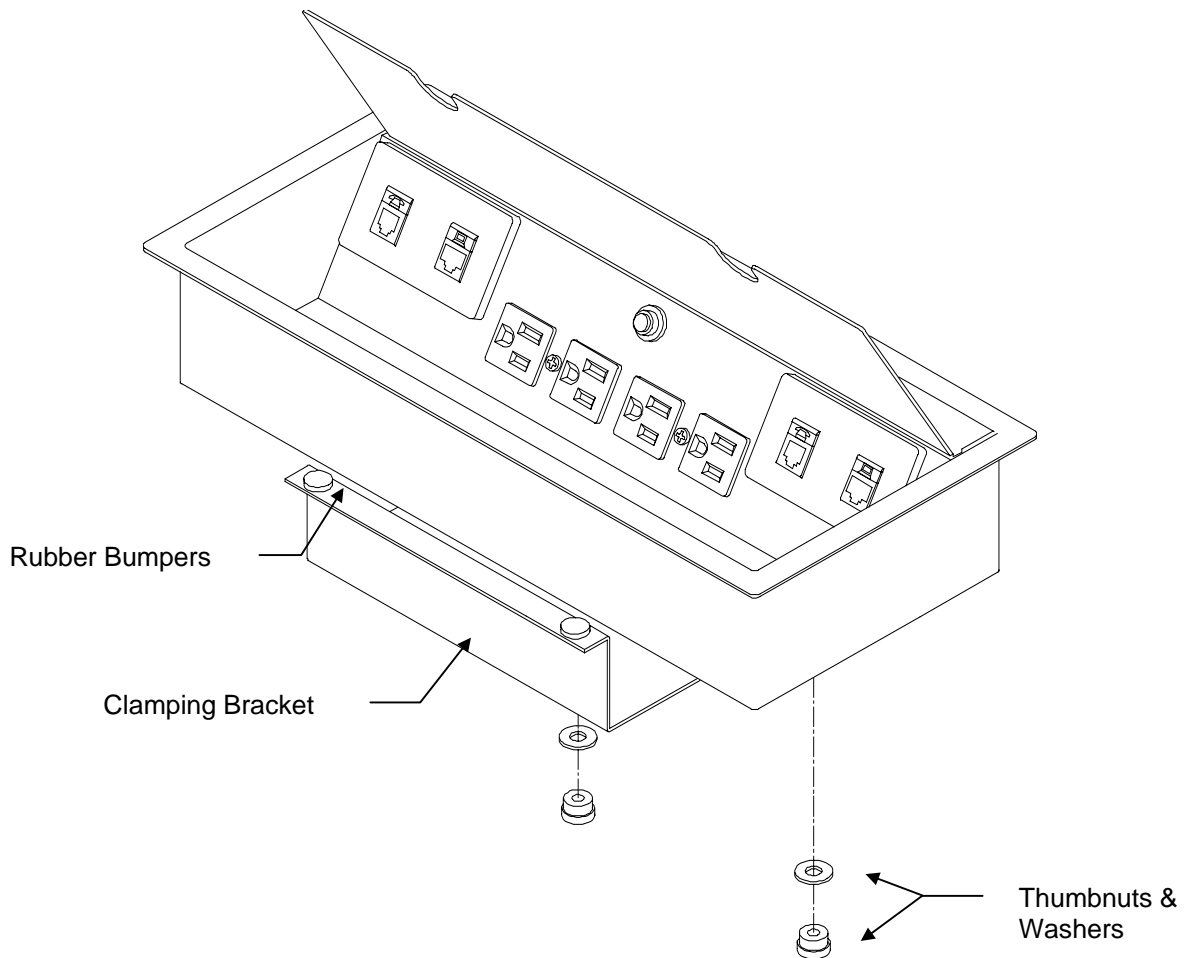

1. Select the location on the table surface for installation of the Interface.
2. Remove a section of the surface measuring $13\text{-}5/8" \times 6"$.
3. Remove the installed Clamping Bracket from the underside of the Interface by removing the thumbnuts and washers.
4. Attach rubber bumpers to upper flanges on Clamping Bracket as shown.
5. Insert the Interface through the opening in table surface until flange is flat on surface.
6. From the underside of the table surface reinstall the Clamping Bracket, thumbnuts & washers. Tighten until Interface is snug in top.
7. The holes alongside the data openings in bottom of Interface can be used for strain relieving data cables if needed.

INTERFACE I UT & INTERACT UT LID PIVOT ASSEMBLY INSTALLATION SHEET

Table Preparation

Hole #3, Pivot Hole
Ø .20 (13/64) x 3/4" Deep
Both Sides

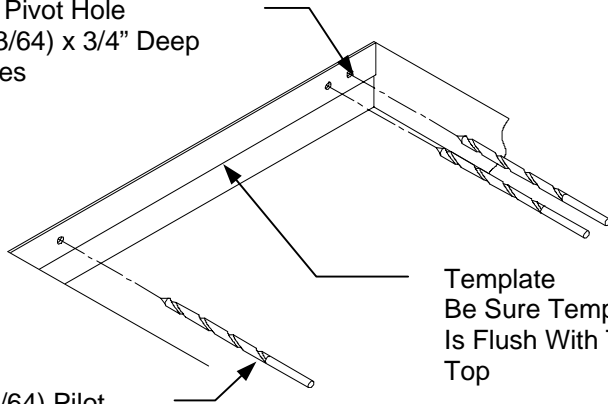

Template
Be Sure Template
Is Flush With Table
Top

Ø .10 (7/64) Pilot
Drill
3 Places

1a. Cutout table, where Interface I UT will be mounted, to size 13-3/4" x 6-3/8". Dimension is finish surface to finish surface.

1b. Cutout table, where Interact UT will be mounted, to size 8" x 4-1/2". Dimension is finish surface to finish surface

2. Using template provided drill three Ø.10" (7/64) pilot holes into both cutout sides as shown. Hole #3 is the hinge side. Drill all holes 3/4" deep. NOTE: Use care to ensure template is flush with top of table and drill doesn't pierce table surface

3. Remove template and enlarge hole #3 for pivot pin clearance, Ø .20 (13/64). NOTE: Use care not to pierce table surface.

Mounting Pivot Assemblies

1. Determine position of each Pivot Assembly and locate the four #6 x 3/4" flat head screws provided.
2. Insert pivot pin into hole three on either side of cutout and attach Pivot Assembly to side of cutout with two #6 screws as shown. NOTE: Use care when tightening screws to ensure table surface isn't damaged during installation.
3. Mount other Pivot Assembly to other side of cutout as shown.

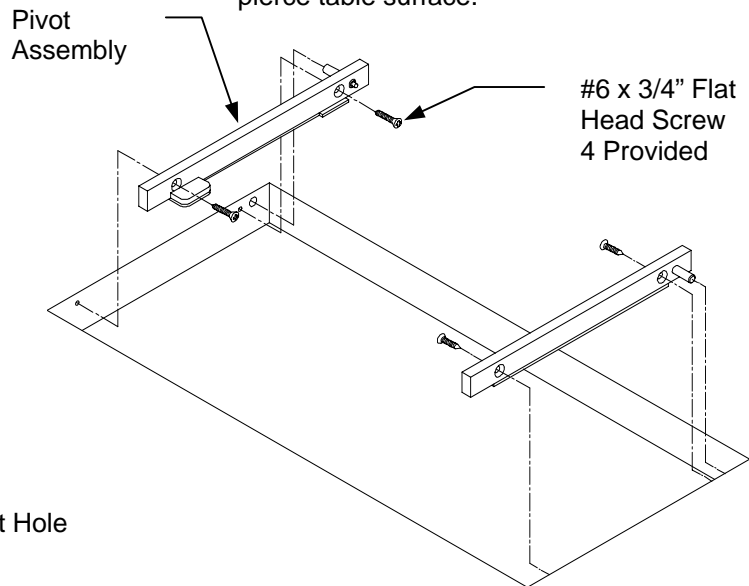

Pivot
Assembly

#6 x 3/4" Flat
Head Screw
4 Provided

Lid Assembly & Installation

1. Remove red liner from adhesive on Lid Support and adhere to lid as shown. NOTE: Lid must be 1/4" thick at point of mounting, rabbit wood lids as needed. Top size is 12-13/16" x 5-3/4" for Interface & 7-1/16" x 3-7/8" for Interact, Recommended max top thickness 3/4".
2. Check lid to clearance between pivots, between 1/32" & 1/16" total is sufficient for proper operation. If more or less clearance is needed remove Pivot Assembly and extend or retract pivot pin as needed.
3. Place plastic washer over pivot pin and engage one side into Lid Support pivot hole.
4. Using small screwdriver depress remaining pivot pin and repeat step 3 for other side. NOTE: Use care not to scratch finish surface. Once lid is in place removal from table requires complete disassembly, which can damage lid and/or table.
5. Test lid for proper operation.

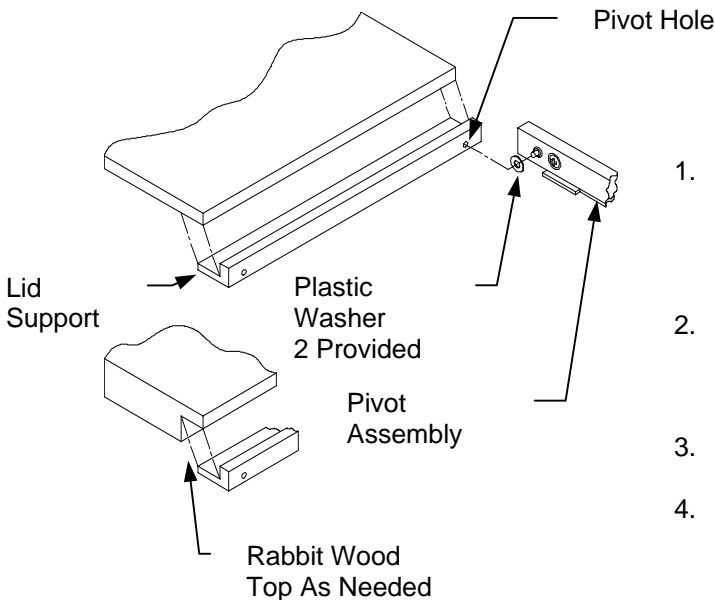

Lid
Support

Plastic
Washer
2 Provided

Pivot
Assembly

Rabbit Wood
Top As Needed

Pivot Hole

INTERFACE I UT INSTALLATION SHEET

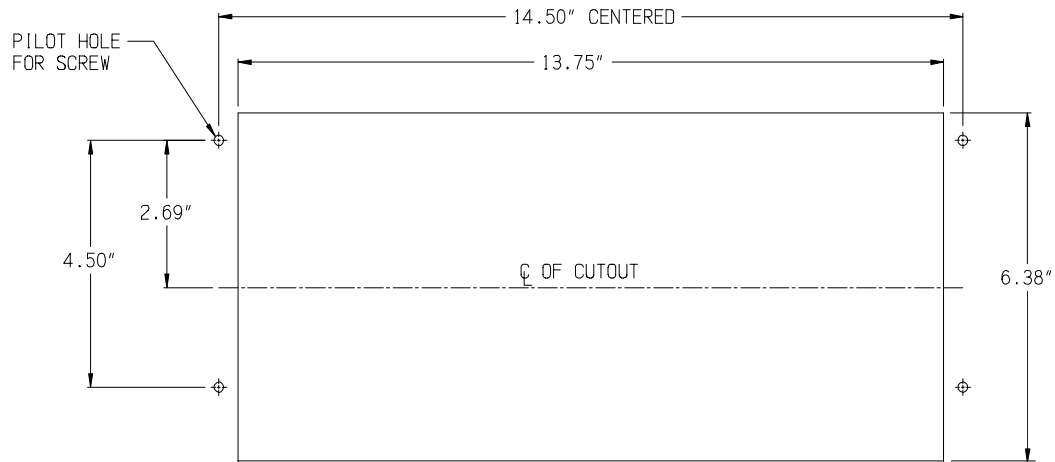

Recommended Table Cutout

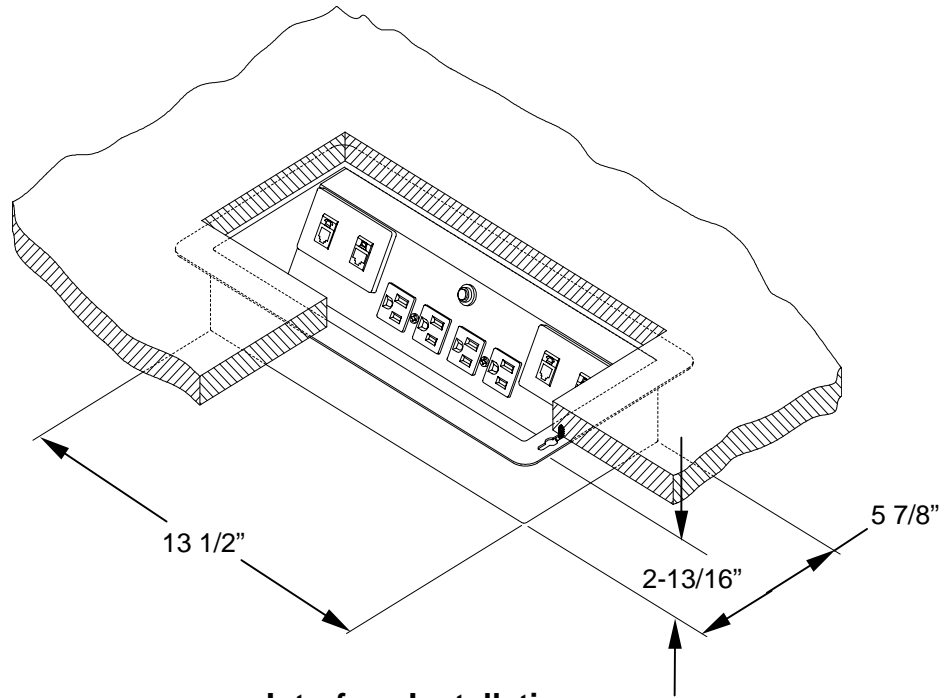

Interface Installation

1. Use Table Cutout above for cutout size and screw locations.
2. Mount Interface utilizing keyholes and slide into position.
3. Fabricate top as required.

INTERFACE II TT INSTALLATION SHEET

Table Cutout

(Fits surface thickness from 3/4" to 1-3/4")

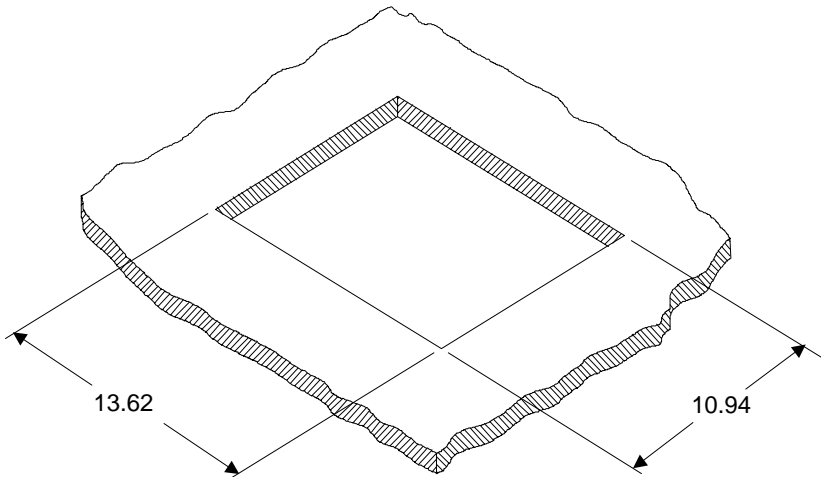

- Step 1. Select the location on the table surface for the installation of the Interface.
- Step 2. Remove a section of the surface measuring 13-5/8" x 10-15/16".
- Step 3. Remove the Clamping Bracket from the underside of the Interface by removing the thumb-nuts and washers.

Interface II Installation

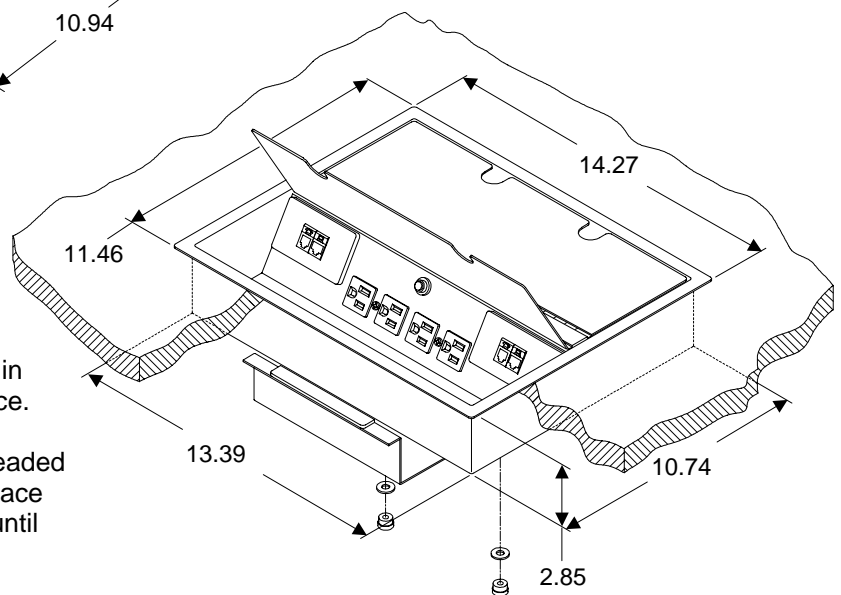

- Step 4. Insert the Interface through the opening in table surface until flange is flat on surface.
- Step 5. From the underside of the table surface slide the Clamping Bracket over the threaded studs and secure to bottom of table surface with thumb-nuts and washers. Tighten until Interface is snug.
- Step 6. Attach the power supply cord.

Caution: Test each outlet for continuity and grounding prior to use.

- Step 7. Connect Tel-Com as needed and snap plates into face of Interface.

INTERFACE II UT INSTALLATION SHEET

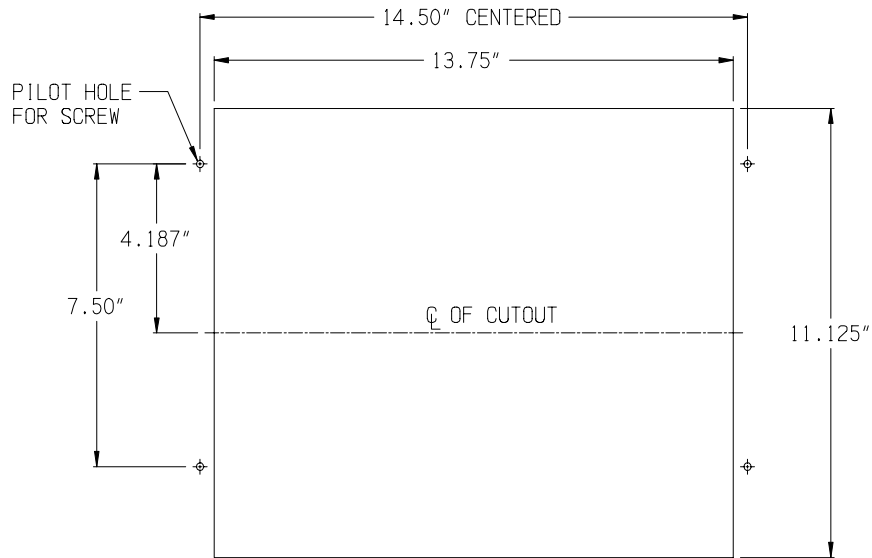

Recommended Table Cutout

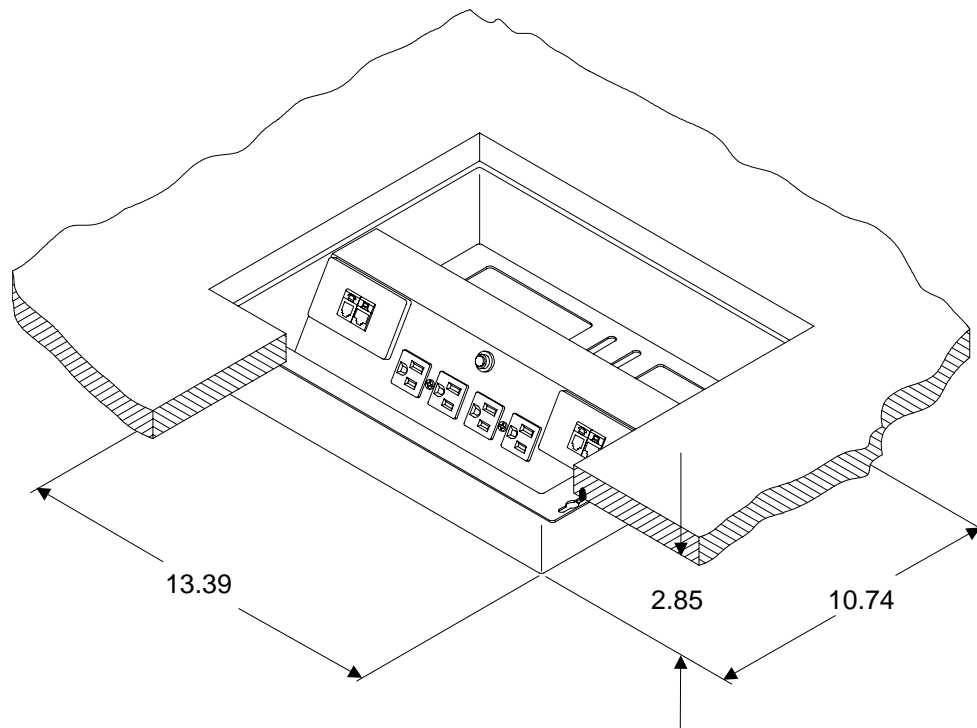

Interface Installation

1. Use Table Cutout above for cutout size and screw locations.
2. Mount Interface utilizing keyholes and slide into position.
3. Fabricate top as required.

TOP NOTCH 2 INSTALLATION SHEET

1. Follow the illustration in Figure 1 for cutout size in table as well as the area that gets relieved down to a depth of 1/16".
2. Insert Top Notch 2 into cutout and using threaded studs, washers and plastic nuts secure clamp to Top Notch 2 using appropriate hole in clamps, see Figures 2 & 3.
3. After clamp is in place insert and tighten down on clamping screws to firmly secure Top Notch 2 in table cutout.
4. The Top Notch 2 comes pre-wired for both the power and the data; therefore no internal connections are required. Plug in power patch cord as needed.
5. Check for proper operation and movement of the Top Notch 2.

Figure 2

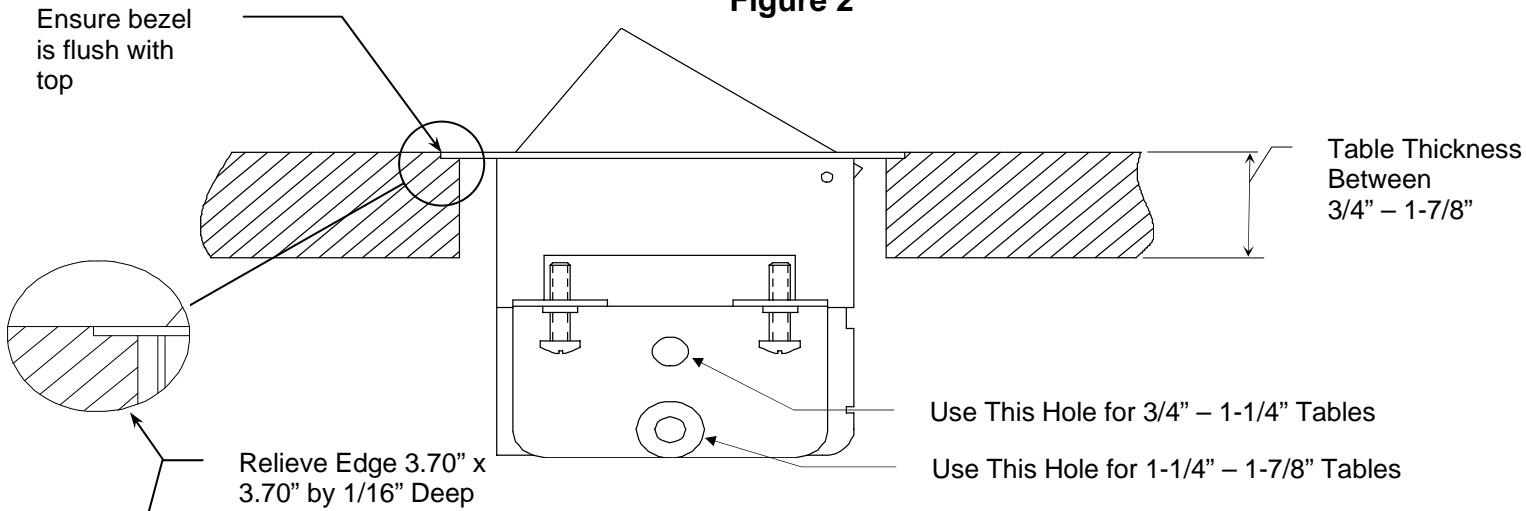

1/4" Radius Max
Typ. 4

2.86 Tables 3/4" - 1-1/4"
3.39 Tables 1-1/4" – 1-7/8"

Figure 3

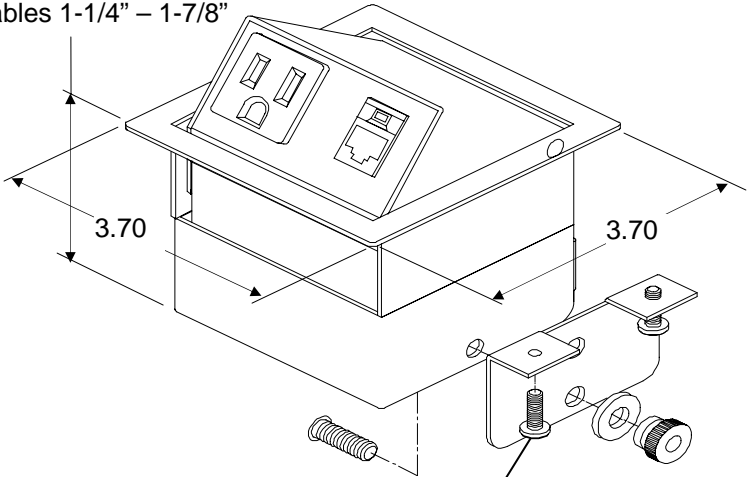

Figure 1

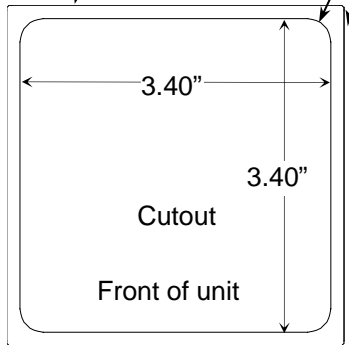
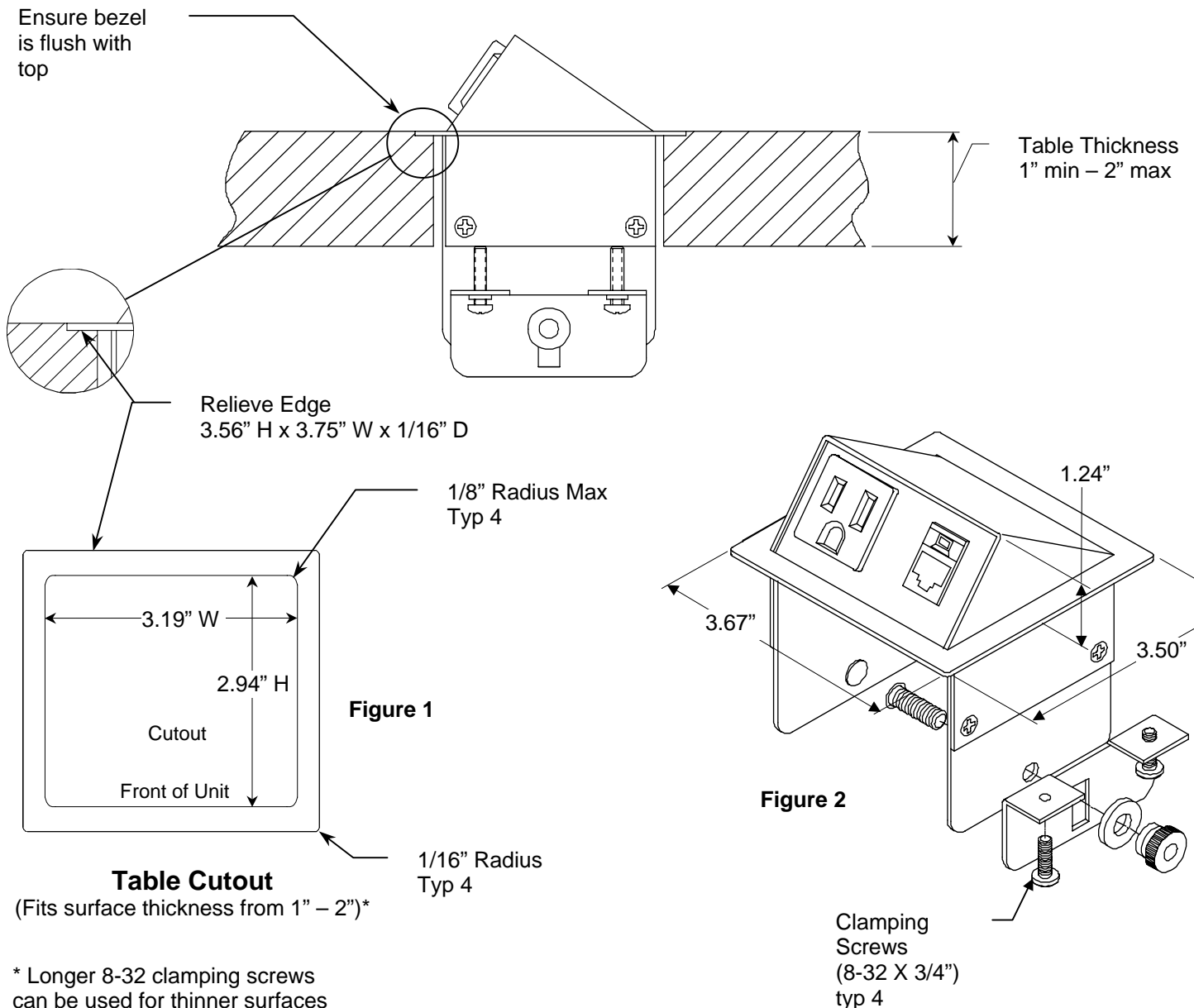

Table Cutout
(Fits surface thickness up to 1.88")

ELECTRI-CABLE ASSEMBLIES
Tel: 203.924.6617 Fax: 203.924.6687
www.electri-cable.com

TOP NOTCH INSTALLATION SHEET

1. Follow the cutout illustration in Figure 1 for cutout size in the table as well as the area that needs to be relieved down to a depth of 1/16"
2. Insert Top Notch into cutout and using threaded studs, washers and plastic nuts secure clamp against the bottom of the table. See Figure 2.
3. After clamp is in place insert and tighten down on clamping screws to firmly secure Top Notch in table cutout.
4. The Top Notch comes pre-wired for both the power and the data; therefore no internal connections are required, simply connect cords as needed



TRANSACT INSTALLATION SHEET

1. Follow the template, Figure 1, for cutout size.
2. Insert Transact into cutout and using studs, washers and plastic nuts secure clamps snugly against the bottom of the table. See Figure 2.
3. After both clamps are in place tighten down on clamping screws securing the Transact in table cutout. Use caution not to over tighten screws.

NOTE TO TELEPHONE/COMPUTER INSTALLER

Some jacks permit installation from the front of the housing. For this feed the cables up through the shutter bushing on the underside of the Transact and out the clearance holes.

If you require access to the inside of the housing, remove the one pan head screw on the underside of the Transact. This will allow you to lift the housing up and away from the retaining bracket. This will provide access to the inside of the housing. Use caution not to scratch the finished surfaces.

Figure 1

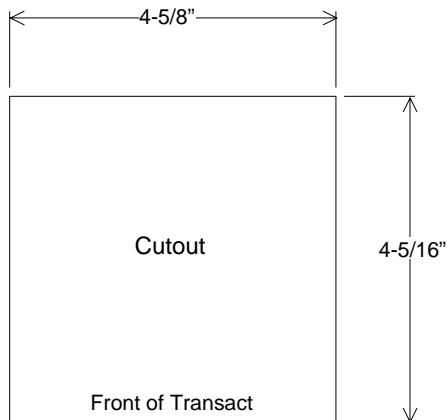
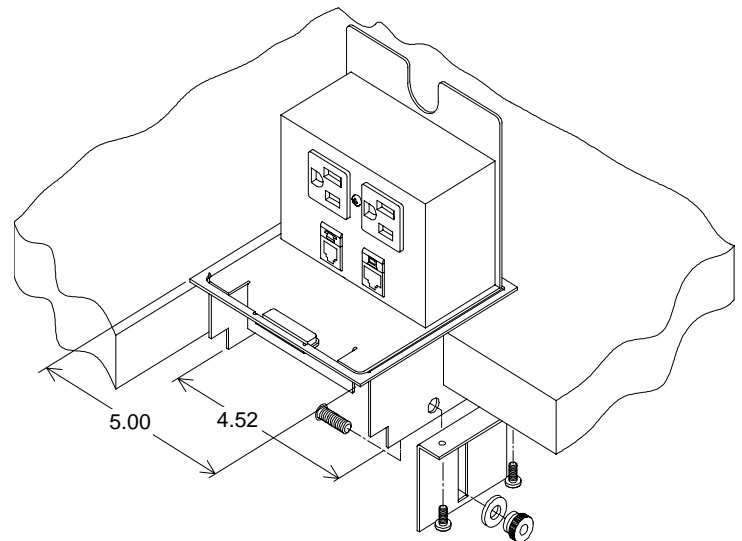

Table Cutout

(Fits surface thickness up to 1.375")

Figure 2



TRANSACT JR INSTALLATION SHEET

1. Follow the illustration in Figure 1 for cutout size in table as well as the area that gets relieved down to a depth of 1/16". Note: An area to the rear of the Transact Jr. is required for clearance of the wires when the Transact Jr. is in the closed position. See Figure 2.
2. Insert Transact Jr. into cutout and using threaded studs, washers and plastic nuts secure clamp against bottom of the table. See Figure 3.
3. After clamp is in place insert and tighten down on clamping screws to firmly secure Transact Jr. in table cutout.
4. The Transact Jr. comes pre-wired for both the power and the data; therefore no internal connections are required.
5. Check for proper operation of the Transact Jr.
6. Optional – Cord may be attached to clamp using holes provided as shown in Figure 2. Be sure to provide an adequate service loop to ensure proper operation of the Transact Jr.

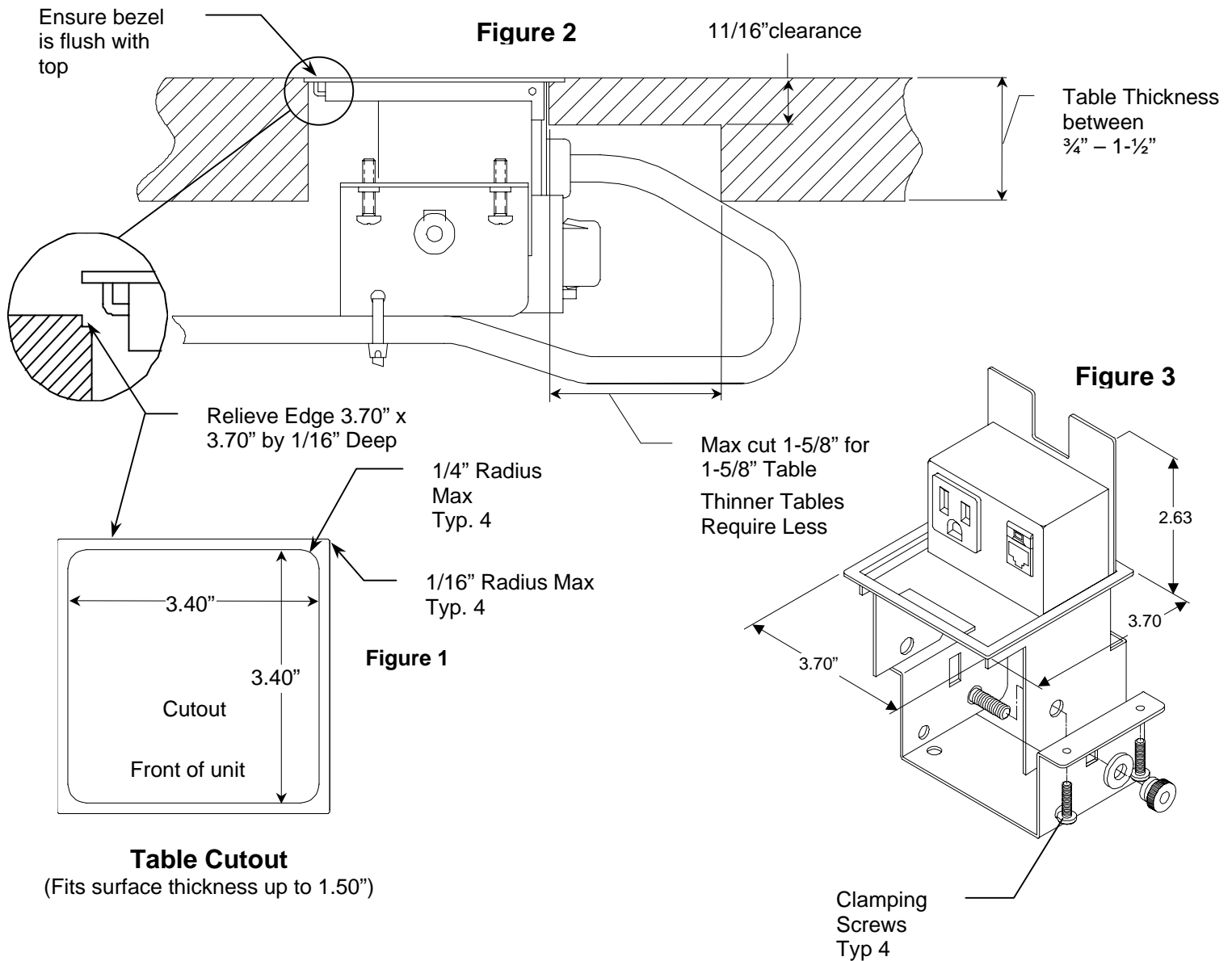

UDT/VD SM INSTALLATION SHEET

1. Upon deciding location of UDT/VD SM cutout face as shown below, see chart for recommended dimensions.
2. Drill pilot holes for mounting screws; they are horizontally centered in cutout on 10" centers.
3. Tighten screws until there is approximately .06 between screw head and mounting surface.
4. Install UDT through cutout and insert screws through key slots and slide UDT to right to lock in place.
Note: if UDT is not held securely, remove and tighten screws farther.

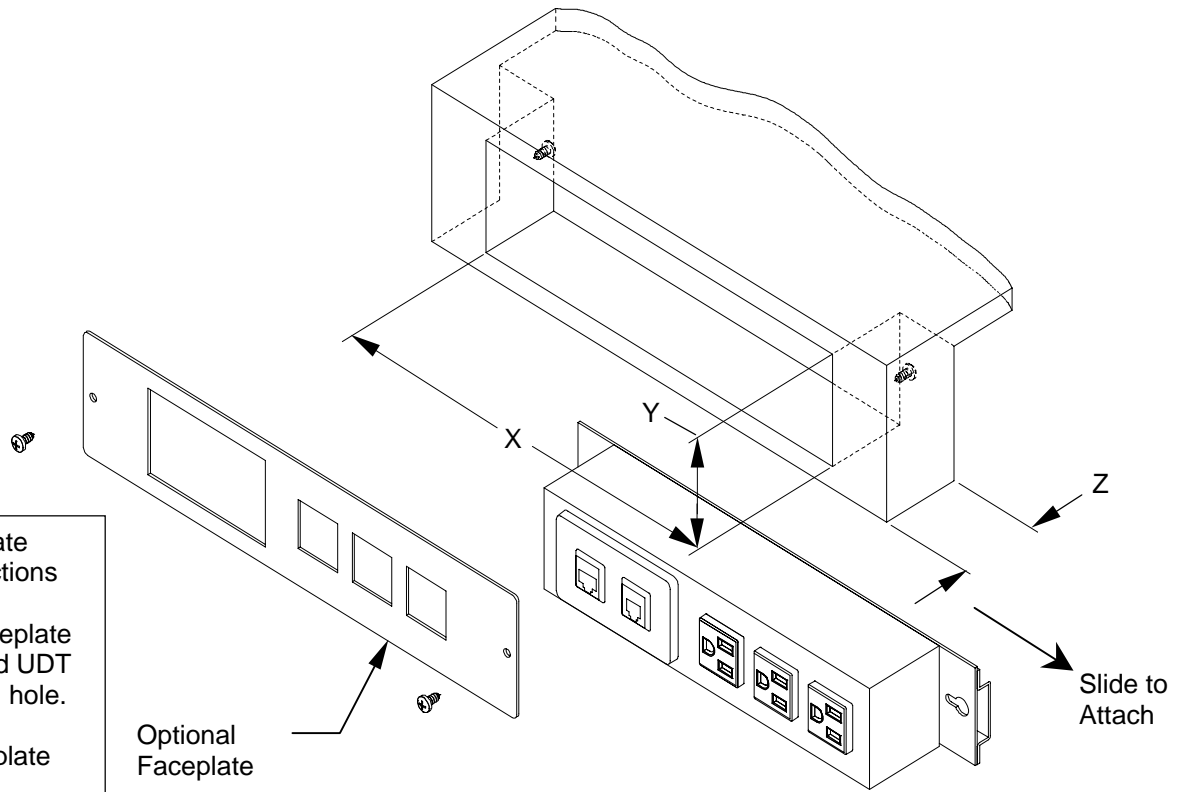

Optional Faceplate Mounting Instructions

1. Position Faceplate over installed UDT and pilot drill hole.
2. Mount Faceplate with screws provided.

| | UDT Dimensions | | |
|----------------|----------------|-------|-------|
| | X | Y | Z |
| UDT2/VD SM 6½" | 7.10" | 2.52" | 1.75" |
| UDT2/VD SM | 9.60" | 2.52" | 1.86" |
| UDT3/VD SM | 9.60" | 2.52" | 1.86" |

UDT/VD TM INSTALLATION SHEET

1. Upon deciding location of UDT/VD TM cutout face as shown below, see chart for recommended dimensions.
2. Drill pilot hole for left mounting screw by measuring .20" to the left of the centerline of the cutout and back from mounting face dimension "Z" (if flush mounting with optional faceplate).
3. Measure .75" over from first pilot hole and drill second pilot hole.
4. Tighten screws until there is approximately .06 between screw head and mounting surface.
5. Install UDT through cutout and insert screws through key slots and slide UDT to right to lock in place.
Note: if UDT is not held securely, remove and tighten screws farther.

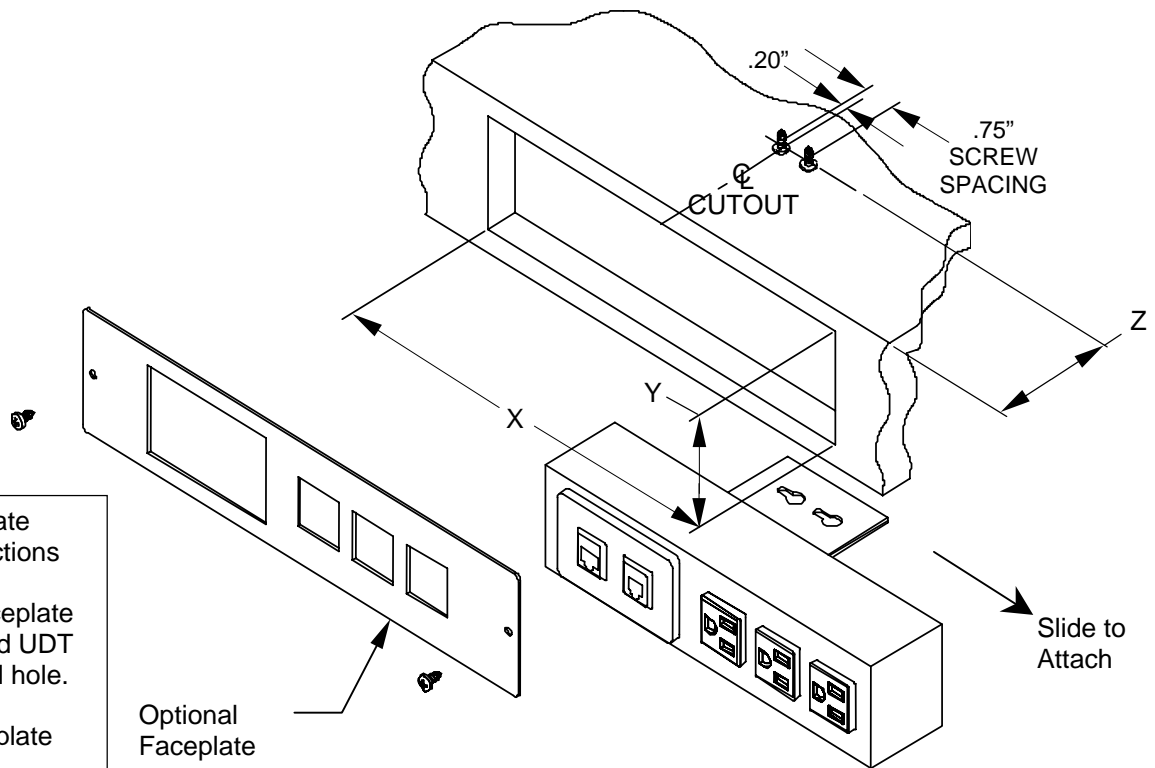

Optional Faceplate Mounting Instructions

1. Position Faceplate over installed UDT and pilot drill hole.
2. Mount Faceplate with screws provided.

Optional Faceplate

UDT Dimensions
X Y Z

| | | | |
|----------------|-------|-------|-------|
| UDT2/VD TM 6½" | 7.10" | 2.52" | 2.60" |
| UDT2/VD TM | 9.60" | 2.52" | 2.69" |
| UDT3/VD TM | 9.60" | 2.52" | 2.69" |