

HorizonLine™

Monitor Lift Computer Tables



Freedom for widescreen monitors.

HorizonLine™

Monitor Lift Computer Tables

This simple, elegant design presents an efficient, flexible classroom work space. The monitor port lets the widescreen LCD to be positioned above and below the work surface on an under-mounted LCD arm.

The LCD arm gives a full range of motion: 360° swivel, 90° tilt, and forward to rear excursion within the port hole.

The screen may actually be parked under the surface when not in use.

The screen may also be positioned for a standing presenter to view, or to turn to show the class.

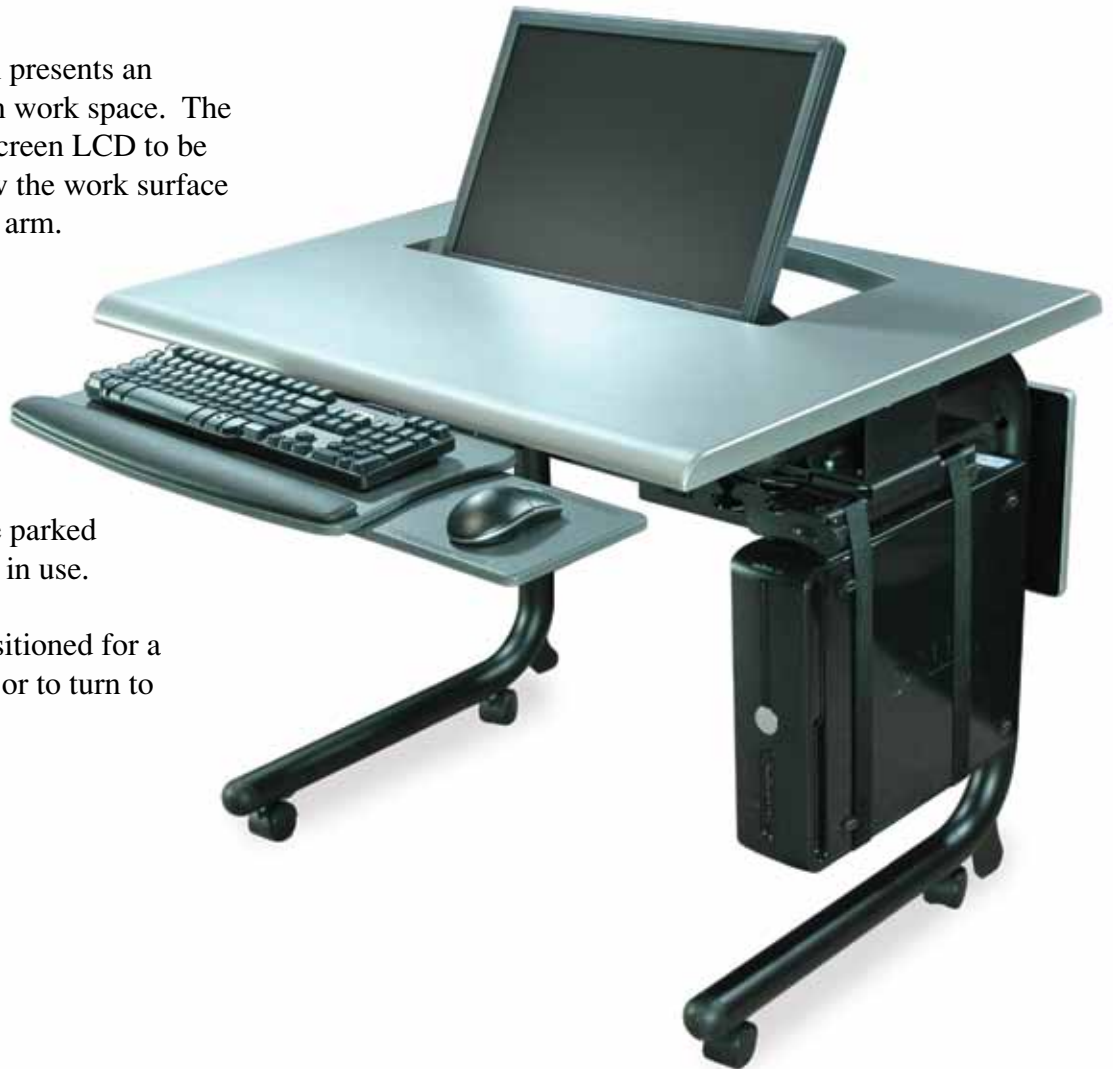

Available in singles and doubles, Horizon-Line™ Monitor Lift Tables keep cable clutter organized behind an attractive modesty panel.

The CPU is suspended from the robust leg bracket, engineered for long performance life. The EZ-Cinch™ CPU holder provides complete IT access with a clean, designer profile.

The LCD Arm lets you adjust the tension to balance the weight of your monitor. Wire management is provided for a neat appearance.

Choose locking casters for mobility, or floor glides for more stationary use.



HorizonLine™

Monitor Lift Computer Tables



Specifications

- Top is 30mm (1.18") MDF, with contoured front and back edges, square side edges
- Top surface finish is 3D thermofoil, 12mil, with seamless edges.
- Modesty Panel, 19mm (.75") MDF, 254mm (10") height x 36" or 72" width, finished in matching 3D thermofoil, 12 mil.
- Monitor port is 584mm x 266mm (23" x 10.5") to accommodate monitors case width up to 558mm (22").
- Monitor lift arm is spring tensioned to balance monitors of various weights. VESA mount compatible at 75mm and 100mm. 360° swivel, 90° tilt, 406mm (16") height, 360° pivot from base, limited by monitor port hole.
- Keyboard tray options: flipIT® dual arm, retractable, steel construction, 508mm x 203mm (20" x 8") platform with phenolic mouse pad, extending right or left, 200mm x 200mm (7.87" x 7.87"). (Shown on double table) Or, single arm, articulating keyboard tray, 6" height adjustable 2.375" up and 3.625" down) with gel wrist rest and 8.5" diameter tilt & swivel mouse pad, mounted right or left. (shown on single table).
- CPU holder options: EZ-Cinch™ (shown), or Li'l Brig™, or Brig™. All mount to C-leg bracket. See web site for specs.
- C-Legs: 50.8mm (2") tubular steel, finished black, black nylon bullnose endcaps; wire management holes at base and midline with modesty panel, outfitted with stabilizer fins for 25.4mm (1") steel levelers or casters.
- Wire management: J-channel with ID 25.4mm x 38mm (1" x 1.5"); overall dimensions 25.4mm x 76.2mm x 457mm (1" x 3" x 18").
- Option: WireWonder™ wire manager (shown) steel construction, 63.5mm x 95.25mm x 448mm (2.5" x 3.375" x 17.625")
- Option: Locking carpet casters.
- Option: 6-outlet, 12 AMP power strip with 10' cord (shown)

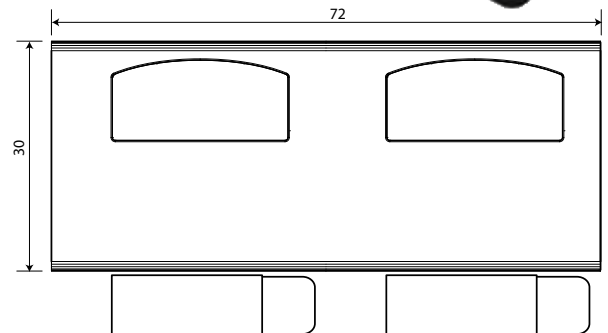

SHL-363030-RK/LC
Single table
with casters

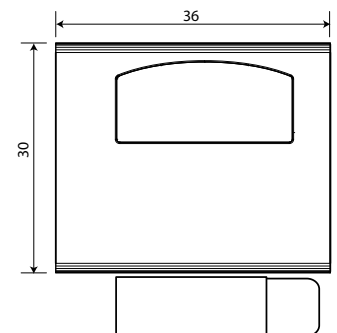

DHL-723030-RK/LC
Double table
with casters