



SMARTDESKS®

where design meets technologysm

Catalog 2019-20



Let's create something just for you

The natural beauty of wood.

Its richness comes from having distinct, individual characteristics. It ages. It looks different depending on its grain direction orientation relative to the light source.

When the mill produces veneer, our veneer specialist will select the premium veneer to ensure the best product quality. Selecting from the top 1-2% of veneers, our veneer specialist chooses only the grade 1 and premium quality veneers which meet our customer's quality requirements. Once the veneer is selected, the veneer specialist will meticulously shape and align the veneer layups to ensure both continuity and artistic excellence. The veneers are available in a variety of patterns and cuts to include ¼ cut, full cut, rift cut, and composite veneer. We offer white oak,

maple, walnut, ash, mahogany, sapele and other special veneers upon request.

Stain to Match Color Service: No Upcharge

We have a unique process of developing our own colors through our "Stain to Match" program. If you have a color to match, we will match it and send it back for your approval. This service gives you complete creative control without limits. We offer this without upcharges.

Where design meets technologysm

- Power data troughs, pop-ups and grommets—a huge selection and all configured custom for your integration requirements
- Wire management keel base design may be specified to keep cables concealed, yet accessible.

- flipIT® monitor mounts, motorless monitor lifts and laptop safes may be integrated—our patented products.
- FFIT Floor® under floor power and data distribution.
- Included: floor plans, product design and IT integration plan—all as part of the process.



Custom Piatto Huddle Tables for Data Visualization

Teaming Center | Collaborative Conference Table

Ed Technology IT staff for University of Notre Dame's Mendoza College of Business evaluated flipIT® and loved the way the display is actually mounted into the desktop.

Screens give full visualization of the large displays used in collaboration groups, making it easy to take advantage of the intuitive controls used to permit any screen in class to be selected for display on any screen. Mendoza's Data Visualization Collaboration Space has total flexibility to not only control a single presentation for the 70-seat classroom, but it also permits local control of eleven simultaneous sessions in full break-out. The space has scheduled free time for individual and small groups to work ad hoc to prepare for class sessions.

To facilitate technology integration, SMARTdesks® customizes each table specifically for the technologies and communication techniques envisioned for the space.

Floor plans and project management support are included. *Call us or visit online and we can discuss your next project.*

PIATTO FLIPIT HUDDLE

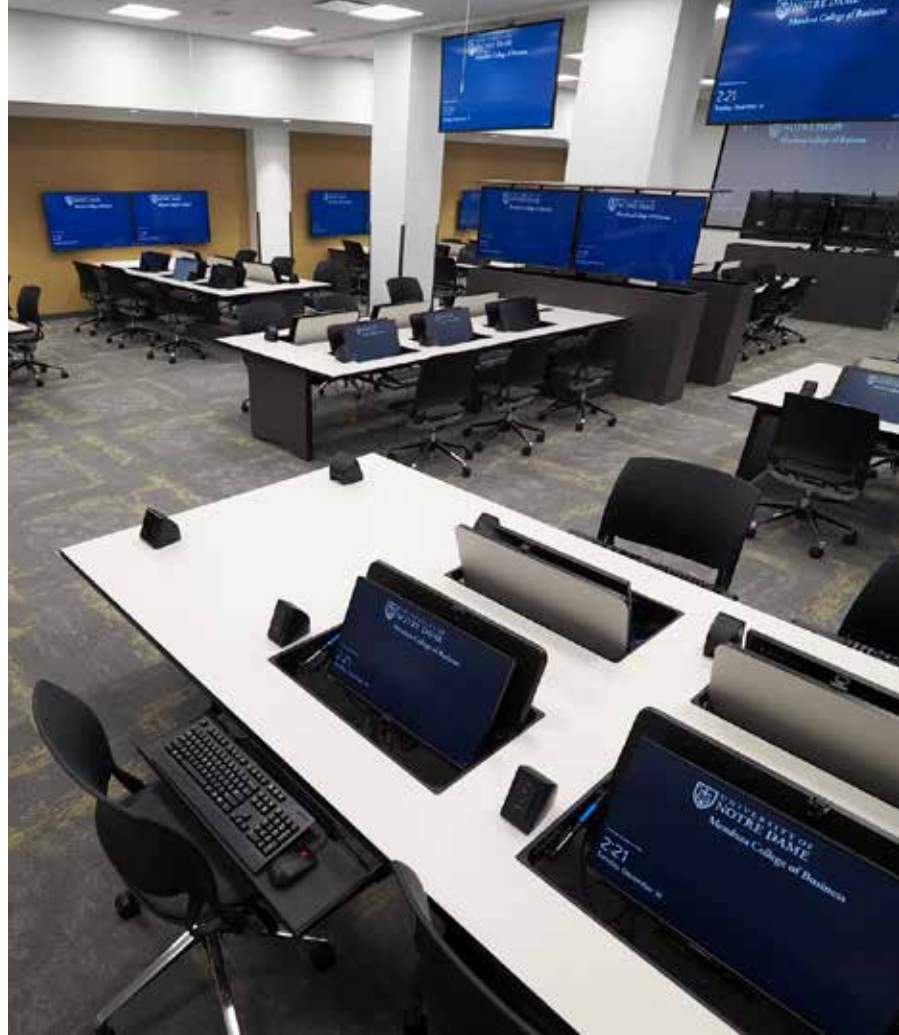

Boost®

Give your collaboration a Boost!

Perfect for a small meeting space, a huddle room, or as a center for an open-plan learning space. The elegant design presents a video display in a motor-less flipIT-Lift.

HuddleVu HDMI Video Switcher allows 1 to 4 users to

- Collaborate and share ideas on your computer screen with others
- One button press inclusion of users
- No software or programming required
- Simple installation
- Hardware and cables included
- Conversion kits available for VGA and audio input
- Footprint: 48 x 60 oval

Share the vision.
Present the supporting data.
Reach consensus.
Change the world for the better.
All you need is a Boost.

BST



HuddleVu HDMI Video Switcher allows 1 to 4 users to plug in and power their laptops or other input devices and simply push a button to display their desktop information on the main display.

Storage cabinet has locking door, rack rails, two adjustable shelves, and six-outlet power strip.



Collab®

Customized for your technical and learning goals.

Flexible Arrangement is the key to the Collab Studio Environment. Students freely interact student-to-student, student-to-teacher, student-to-computer, and teacher-to-class. The Collab Table must support everything simultaneously so activities of learning can be changed at will.

Laptops are installed, tethered and connected to power and data at all times. The genuine flipIT® Laptop Safe permits lockable access control. When in use, the flipIT® top is lower profile than the laptop screen, eliminating face-to-face visual obstructions—increasing engagement.

The 8x20 inch access hatch permits easy IT access. Power and data is supplied from the floor, totally captured by the Collab Table base. The base conceals all unsightly cables, but provides easy access.

SMARTdesks is your resource for planning learning studio spaces.

Together, let's develop a floor plan that considers your technology and your communication goals.

CLB

Collab® is available with solid tops (without flipIT®).

Also available with flipIT® monitor mounts, flipITLift®, as well as flipIT Laptop Safe® as shown.

Power and Data Connection Boxes are always available to suit.



Exchange®

Experience the flow with
the geometry of interaction

The Exchange Element permits the setup of different shapes to promote the types of interaction. Its ability to assume different collaborative shapes allows the meeting room to be set up specifically to its purpose.

The Exchange™ linear offset is made up of alternating exchange elements: 2 rights and 2 lefts to make a block of 4 elements.

The Exchange™ Collab Triangle is made up of 6 elements: 3 left and 3 right set up in mirror image. This equilateral triangle shape lends itself to the formation of collaboration groups. People are drawn to the corners to huddle up, then have plenty of personal space when it's time to work independently.

The exchange™ pinwheel is made up of 6 elements of the same kind. 6 left is shown. Each workstation has enough personal space for focused privacy without the need for partitions. Screens are angled for privacy. The desktop space to the left works as a place for text materials or as a shared conference space with the neighboring collaborator.

The exchange™ hexagon is made up of 6 elements of the same kind, left or right. 6 left is shown. The desktop space to the left works as a place for text materials. Each workstation has enough personal space for focused privacy without the need for partitions. Screens are angled for privacy.



EXL

Impromptu round circle meetings can easily take place with open sight lines within the group. People use body language to express themselves. Sometimes they need to be open to a group or to a work partner. Sometimes they need to work with independent focus. Whether using text materials, computers, laptops or mobile devices, the ability to move the body for joining or blocking is essential for creative freedom and the ability contribute, synthesize and build consensus.



The Exchange™ Video Collaboration Studio is made up of mirror image exchange elements, two right and two lefts. This configuration is made up of two legs from the collab triangle shape, which when mirrored on the endpoint studio.



iGroup® Tables

Interactive Origami at play!

The iGroup® element is triangular with a curve on the user's side. Made in mirror image left and rights, iGroup elements assemble to form a myriad of interactive shapes.

Get creative with your classroom planning. Change up the arrangement for different group settings. Experiment with different shapes to find out what works best for your students and their learning styles.

iGroup Element dimensions:
42"w x 30"d x 28"h

IGP-4230L | IGP-4230R



Linear Offset
2 Left Elements
2 Right Elements

IGP-SET4-LR-MF-LC
Thermofoil
IGP-SET4-LR-ML-LC
Laminate Tops & PVC Edges



Pinwheel | Hexagon
6 Left Elements



IGP-SET6-L-MF-LC
Thermofoil with contoured edges

IGP-SET6-L-ML-LC
Laminate Tops & PVC Edges



Abstract | Triangle | Maple Leaf
3 Left Elements
3 Right Elements

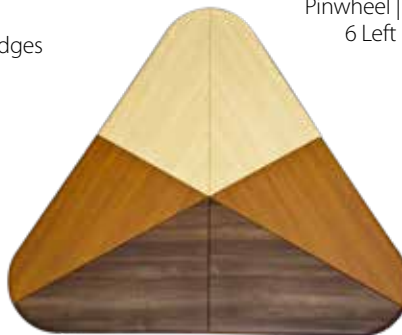

IGP-SET6-LR-MF-LC
Thermofoil with contoured edges

IGP-SET6-LR-ML-LC
Laminate Tops & PVC Edges



Quint™ Active Learning

The Quint ...essential system

Mosaic tile arrangement is the inspiration for Quint's five-sided top. In contrast to forms with even numbered sides, the five-sided shape allows a different freedom in creating forms and shapes for group interaction.

The Quint desktop defines a personal space that can either fit tightly together for close interaction, or can spread apart slightly to increase personal space without completely disconnecting from the group. The loose-tight relationships are easy to facilitate, resulting in uniquely organic arrangements that defy description, yet make perfect sense for spontaneous arrangement.

Quint establishes a personal space that can be controlled by the users, themselves, to reach a comfort zone for the group.

Width 24"

Height 29" or variable

QNL



Trapeza® Tables

Create a collaborative learning environment

Trapeza's trapezoidal shape easily groups to form an array of modular collaborative learning tables that offer an interactive learning experience.

Classroom discussions taking place at collaborative learning tables challenge students to own their role as leaders in management. They formulate topics, pose questions, gain understanding and reach consensus.

Trapeza student desks create a cooperative learning environment, full of excitement and substance for students and faculty alike—all finding a richer collaborative experience, compared to rote memorization of the lecture.

Trapeza Collaboration Tables feature a trapezoidal top, ready for use independently, or in an array of small groupings that can be arranged on the fly.

Overall dimensions 54"w x 24"d x 29" | 31" h
60"w x 30"d x 29" | 31" h

TPF Thermofoil top

TPL Laminate top with PVC edge trim



These examples show Trapeza tables with optional power data ports, SnapChase™ wire management leg, and casters.

Adding connection boxes is optional, and a wide selection is available to suit.

These are laminate with PVC edge; the conference table is done in 3D thermofoil.



Trapeza® can be configured for large groups or small, with refreshing shapes that springboard the flow of communication.



The center section Trapeza from the large conference table can be set up along the wall for serving.



Quark2® | Qstar5®

Ratchet height adjustment for Quark2 and Qstar5

The streamlined shuttle craft profile always looks like it is going somewhere fast. Under its hover board base, five lockable carpet casters allow easy freedom of placement.

Lift the ratchet to your preferred working height

Lift range is 9.45 inches. The lowest position is 30.375" for working on a laptop keyboard in seated comfort. The tops can be raised in twelve matching increments to a standing height of 39.875" atop their five-caster bases. Imagine a seated group with a standing presenter. Each has the capability of changing their position, independently. All may choose to sit or stand in conference at any height, docked or undocked. Freedom.

Q2L | Q2SL





Each Quark2 top is supported by a ratchet height adjustment column that is easily lifted in twelve steps from sitting height to standing. The lowest position is the ergonomic standard for keyboard use. The Qstar2 has docking placement for five Quark2 units.

Wild Cherry Quark2 tops
LAM-W#7054-60
and Cognac Birdseye
LAM-N#W8348V
for the Qstar2 and
wall docking system are
shown, but you can be
creative about your selection
without fear of choosing
anything that clashes when
you use our designer
color suggestions.



For Quark2 Shuttle craft Wall Docking: three section designs can be used together to organize and dock groups of two Quark2. The Shuttle Docking System provides wire management, power distribution and optically pleasing placement and spacing for the Quark2 workstations.



Piano Solo

A conferencing instrument for collaboration

Piano Conference Tables have the perfect shape for collaboration with people and technology. Ideal for teleconferencing with one screen and one camera: All faces are in view, and the flipIT monitor supports present data screens with maximum comfort. And if the screens are not needed—away they go!

Turn your “bored room” into a technology forward collaboration suite

Piano Solo 5 + 1 flipIT® stations

Piano Solo 7 + 1 flipIT® stations .

Piano Solo 9 + 2 flipIT® stations

PIANO SOLO | SONATA FINISH

PIANO SOLO | CONCERTO FINISH



The Sonata designation means that the top is finished in 3D thermofoil and has contoured self edges. Because less hand work is involved, the Sonata costs less; however, it performs just as well as its Concerto counterpart.



The Piano Concerto finish group is a mixture of laminates or veneer with stained wood edge molding.

The MVC Podium, motorized Video Credenza with side cabinets were made for this room.

Piano Duet

More collaboration in a larger space

One of our most popular configurations for a technology-rich collaboration space. Equipped with flipIT® monitor mounts or laptop safes, reference data is instantly accessible and sharable. The cable pass-through under the lid to permits instant deployment of conference phone and other small accessories or AV controllers, which are otherwise stored in the technology well when not in use.

Piano10 Duet | 10 flipIT® stations

Piano14 Duet | 14 flipIT® stations

Piano18 Duet | 18 flipIT® stations

PIANO DUET | SONATA FINISH

PIANO DUET | CONCERTO FINISH

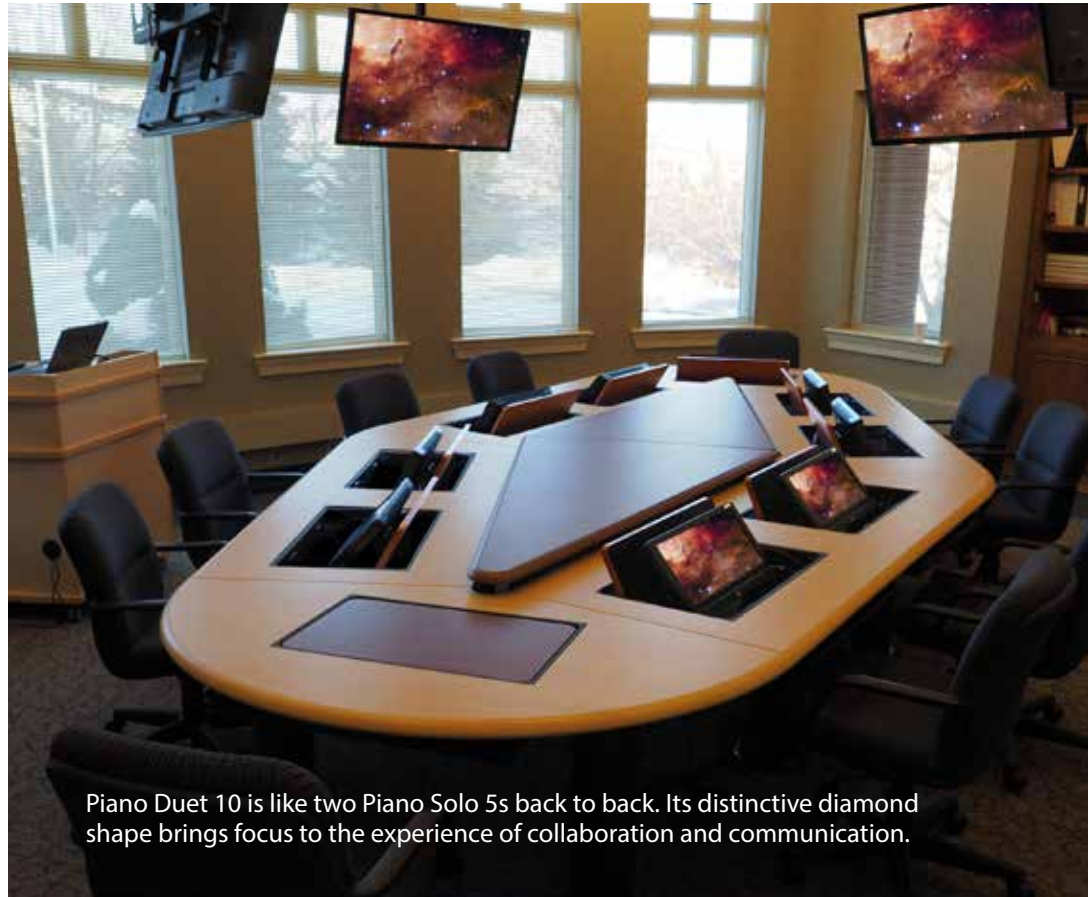

Piano Duet 10 is like two Piano Solo 5s back to back. Its distinctive diamond shape brings focus to the experience of collaboration and communication.



Piano Duet 18 is like two Piano Solo 9s back to back. The experience of collaboration and communication are enhanced regardless of the number using the room.

Motif®

Modular | flipIT® optional | Build to suit

A perfect combination of utility, economy, and beauty for the modern electronic learning environment. Besides setting up in rows with the speaker in front, U-shape, face-to-face, and open-ended configurations are customized to the needs of the floor plan.

The flipIT® Monitor Mount keeps the screen at a low profile so it does not obscure the sight lines of the participants and camera. Retractable keyboard tray actuates flipIT® opening.

FlipIT® Laptop Safes for laptop security between sessions—a lockable charging station at the point of use! When closed, the top surface is usable as a regular study table. When open, the laptop can be freely positioned for use. The low profile lid is even lower than the laptop screen, which promotes unobstructed sight lines.

FTI



Piatto®

Made to order | Arch-End | Boat | Rectangle

Piatto Custom Computer Conference Tables are custom configured to your conference space for computer, laptop, AV, and mobile device usage. Finished in HPL or veneer with stained hardwood edge molding, Piatto is fashion forward, formal contemporary styling

Each Piatto Computer Conference Table is scaled for the number meeting in the conference room. Appointed with accessible power and connection panels or troughs with connectors you specify; and also, flipIT Laptop Safe or flipIT Workstations as options.

Develop your plans for a Piatto with our Design Center. Make a wish list and receive input from our experienced team.

A configured solution for any communication space.



Arched ends and contemporary styling, with flipIT Laptop Safe®, installed at NYC Department of Records.

PIATTO

Piatto may be customized with any flipIT® monitor mount, lift or laptop safe.

Rectangular with traditional molding and veneer throughout, appointed with flipIT® workstations. The credenza under the large display was custom made to coordinate and match.



Presence Podium

Adjustable height | AV ready | Customized to order

The Presence Podium is height adjustable so every presenter is served with commanding stature. Contoured, solid top with hand holds.

Top is served with data connections through flexible conduit. Available with one or two pull-up shelves for document camera and projector stand. Rack mount storage bay.

Cubby holes for books, water bottles, small accessories. Electronic combination lock on user side, locking removable access door on reverse side.

Dimensions:

37w x 26d x 36.75 to 48.50 vh

48w x 26d x 36.75 to 48.50 vh

PRS



MultiMedia Podium

flipIT Multi-Use | Tech Storage | Customized to order

MVC Series Podium is designed for technology-forward collaborative conference environments. Goes well with Piano Conference Tables.

The flipIT® Monitor Mount keeps the screen at a low profile so it does not obscure the sight lines of the participants and camera. Keyboard tray actuates flipIT® opening.

The equipment bay holds CPU and other AV components. Equipment bay doors lock for security. It rolls on heavy duty casters so it can be positioned for the most pleasing camera angle.

Dimensions 34w x 32d x 42h

MVC



MFI Series flipIT® Podium

flipIT Multi-Use | Tech Storage | Customized to order

The MFI Series provides an ergonomic presentation platform that is also a secure enclosure for equipment, media, supplies, and a central location for controls.

SMARTdesks' patented flipIT® Monitor Mount provides a semi-recessed view of the display to eliminate any line-of-sight obstruction between instructor and student. The LCD screen is visible to the teacher from behind and to the sides of the podium for freedom of movement while lecturing.

Podiums are 30 inches deep, 42 inches high and are sized in 4 widths: 30, 36, 54 and 60 inches. The narrower versions have storage below and the wider podiums have an additional storage bay to the side.

MFI



MFP Series Podium

Semi-Recessed Display for iMac and AIO

For iMac® and AIO displays mounted on their own stands. Display is semi-recessed into the work surface to eliminate any obstruction of the line-of-sight between instructor and student. The LCD is easily seen by the teacher from behind and to the sides of the computer podium so there are fewer restrictions to moving around while lecturing.

Cabinet is configured with locking single and double equipment and storage bays. Podiums are 30 inches deep, 42 inches high and are sized in 4 widths: 30, 36, 54 and 60 inches. Doors are on 270° hinges to enable them to fold flat against the sides when the lectern is in use.

MFP



MDT Series Podium

Power Data Ports | Tech Storage | Customized to order

The MDT Series configured with locking single and double equipment and storage bays. Podiums are 30 inches deep, 42 inches high and are sized in 4 widths: 30, 36, 54 and 60 inches. Doors are on 270° hinges to enable them to fold flat against the sides when the lectern is in use.

MDT



MLT Series Podium

Power Data Ports | Tech Storage | Customized to order

The MLT Series is designed to support laptop and notebook computers on top of the work surface in a comfortable position for teaching. They all provide a Power/Data Port with duplex outlet and network connections to make it easy to bring your presentation and data into the classroom.

MLT



MSS Series Podium

DownView | Glass Viewport | Customized to order

Stand-up computer podiums integrate an LCD monitor below a tinted and tempered monitor window in the work surface to eliminate any obstruction of the line-of-sight between instructor and student. The work surface area is always totally clear to accommodate printed teaching materials and notes.

Configured with locking single and double equipment and storage bays. Podiums are 30 inches deep, 42 inches high and are sized in 4 widths: 30, 36, 54 and 60 inches. Doors are on 270° hinges to enable them to fold flat against the sides when the lectern is in use.

MSS



iLid DUO® Podium

Twin Monitors | Multi-Use Design | Tech Storage

The iLid DUO® Podium provides Multi-use top that presents dual monitors for ergonomic presentation. Also a secure enclosure for equipment, media, supplies, and a central location for controls.

the iLid® DUO monitor mount provides a semi-recessed view of the displays to eliminate any line-of-sight obstruction between instructor and student. The LCD screens are visible to the teacher from behind and to the sides of the podium for freedom of movement while lecturing.

Podiums are 30 inches deep, 42 inches high and 60 inches wide.

MID



The Flipper

Open Bay Podium

14 rack mount spaces, optional shelves

In a small footprint of only 30x24x45, The Flipper Podium houses 14 rack mount spaces for technology, a retractable keyboard/mouse platform and a 20" display in a flipIT® K19 monitor mount.

Optional folding side shelves on both or either side provide extra surface for doc cams and external controllers. Optional casters for mobility.

MFI-302445-K19



Essential flipIT® Podium

flipIT Multi-Use | Tech Storage | Customized to order

Two synchronized motors provide lift for up to 250 LB load. The twin columns and twin motors are controller synchronized from a zero set point at the lowest position.

FlipIT® Concealed Monitor Mount adds multi-use flexibility. Rack mount space has lockable access from modesty panel.

Base Specifications

- Infinite stop positions
- Speed: 1.35"/sec
- Simple up-down buttons
- Height range: 27" - 46"

Max Load

Rated load including table top: 250 lb.

Functional load: 306 lb.

- Laminate top with PVC edge trim



Lift Roller 2

Two Column Hydraulic Leg | U Base

Supports table top sizes 24" x 48" (min.) to 36" x 72" (max.) with base height range 27.25" to 46.75" for sit to stand, step-less adjustable height, telescoping columns.

Base Specifications

- Infinite stop positions
- Height range: 29" - 48"
- Lift Capacity
 - standard 26 to 66 pounds
 - premium 49 to 89 pounds

Top Sizes and Materials

- Depth 26"
 - Width 60" | 66" | 72"
 - Laminate top with PVC edge trim
- CRL-E8LR2



Lift Roller 1

One Column Hydraulic Leg | U Base

Supports table top sizes 26" depth to 36" | 42" width, with height range 27.25" to 46.75" for sit to stand, step-less adjustable height, telescoping columns.

Base Specifications

- Infinite stop positions
- Height range: 29" - 48"
- Lift Capacity
 - standard 16 to 44 pounds
 - premium 26 to 66 pounds

Top Sizes and Materials

- Depth 26"
- Width 36" and 42"
- Laminate top with PVC edge trim

CRL-E8LR1



202 Ratchet

Two T-base Series 202 Ratchet Legs

Simply lift up on the top to click the bases to your desired height. Each base can be adjusted separately so it's a one person job that is accomplished in seconds.

Base Specifications

- 13 stop positions
- Height range: 24.25" - 33.7"
- Leg color: Black or Silver

Top Sizes and Materials

- Depth 24" | 26"
- Width 36" | 42" | 60" | 66" | 72"
- Laminate top with PVC edge trim

CRL-202RA



Spring Pin

Greatest economy and simplicity

The spring pin adjustment makes this a practical choice, suitable for different grades throughout its long service life.

Adjust the height from 24 to 30 inches in one inch increments. A truly multi-purpose table that serves use with computers, art materials—even lunchrooms.

Base Specifications

- 6 stop positions
- Table height 29" - 35"
- Leg color: Black or Silver

Top Sizes and Materials

- Mesh modesty panel—standard
- Depth 26"
- Width 36" | 42" | 48" | 60" | 66" | 72"
- Thermofoil | Laminate Top



CRL-CRF-BPS

Pedestals

LiftRoller or Ratchet Pedestals

The hydraulic LiftRoller provides unbelievably smooth adjustment up and down with a release lever mounted to the underside edge of the top.

- Hydraulic LiftRoller has infinite stop positions
- No-bounce stop for a solid table top
- Steel roller guidance system
- Cable release with handle specially designed to resist unintended activation
- Easy control of speed with release mechanism
- Height Range: 27.75" - 45"

Ratchet Height Adjust

Looks the same, costs less, but there is no physical assist. You do all of the lifting.

Not offered: TriCloud & BrainStorm tops.

- Height variable: 27.25" - 36.75"
- Range 9.45", increments of 0.78"



Top Sizes and Materials

- Circle 28" 30" 36" 42"
- Squares 30" 36" 42"
- TriCloud 42"
- BrainStorm (lobes) 44"
- Thermofoil | Laminate Top



CRL-CRF-E2LRX LiftRoller

CRL-CRF-E2RAX Ratchet

Floating Balance

Hydraulic Lift with Automatic Load Balancing

German-made leg design equally distributes the weight on the table top over both legs. Can be raised and lowered by one person using only a single release handle. Provides a lifting force to make raising and lowering the table as easy as power steering.

Base Specifications

- Continuous, step-less adjustment
- Height range: 27.47" to 47.15"
- Leg material: steel tubes & base, plastic seal coat

Top Sizes and Materials

- Depth 26"
- Width 48" | 60" | 66" | 72"
- Mesh modesty panel—standard
- Laminate | Thermofoil Top

CRL-CRF-E2CB



Ratchet

Standing desks that do tricks:
Sit | Stand | Store

Changes height easily by two people lifting on each end while holding the base in place with a foot.

Base Specifications

- Ratchet 12 stop positions
- Base height range: 9.45"
- Table height: 27.25" - 36.75"
- Powder coated steel legs, square tubular design, steel base
- Floor leveler glides standard
Locking casters optional

Top Sizes and Materials

- Depth 26"
- Width 36" | 42" | 48" | 60" | 66" | 72"
- Thermofoil | Laminate Top

CRL-CRF-E2RA

OPT-GENUFLIP-KIT

- STANDARD E2RA base without Flip-Top
- OPTIONAL:
Flip-Top OPT-GENUFLIP-KIT for compact storage



- STANDARD
Black fabric mesh modesty panel is black with hook and loop closures for wire management

- OPTIONAL Solid modesty panels
10" deep x table top width
- Match choice of thermofoil top or laminate top with PVC edge
- NeatLinks wire manager channel attaches to solid modesty panels

MAXiDESK™

The perfect companion for any workplacesm

Sit or stand. Use the technology you desire and have your office suite perform for you with comfort you control.

MAXiDESK™ is bundled with Humanscale® M/Flex monitor supports and Humanscale® CPU holder, plus a wireless /USB charging pop-up that will keep your smartphone and other devices ready for action.

PL-MXL

Humanscale® CPU Holder

Mounts directly to table bottom on slide bracket. When the unit is installed, there is no access to release the CPU from its grip, providing effective asset security. Height and width adjustments fit thin client to tower sized CPUs.

Available in black or white trim and in two sizes:

- CPU-HS600 fits cases
3.6 - 10" w x 12-20" h
- CPU-HS200 fits cases
1 - 5" w x 6-12" h



Desk Control 520

The height adjustment is intuitive to use, with simple up and down controls and four programmable presets. Set your perfect comfort height within a range of 28 to 47 inches.

The motorized leg system is rated to 200 pounds of load, including table top. Raising and lowering speed is 1.375" per second.



Dock 150 Wireless | USB Charger

Wireless charging and USB charging in a simple package. The pop-up USB ports can be hidden when they are not in use to keep working surface clean and organized. Each of the three convenient USB type-A ports offers 2.1A (10.5W) of charging power for the mobile devices that do not support wireless charging.

Specifications

- Input: DC 12V, 1A
- Output: 5W Max
- Qi V1.2 compliant IC
- Will charge through surface up to 1/8-in (3.18 mm)
- Charging distance: 6mm Max.

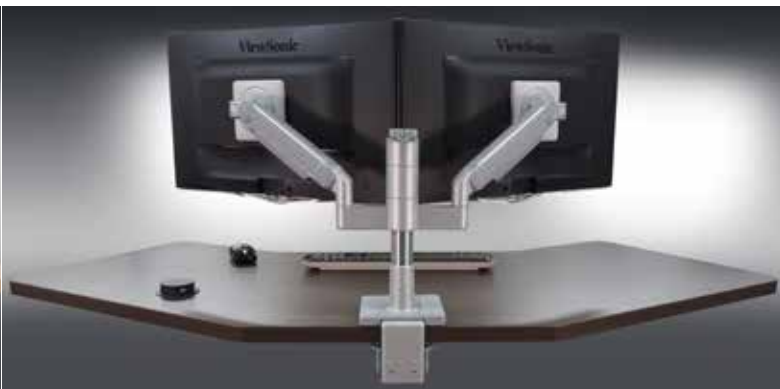

Humanscale® M/Flex M2.1 Monitor Support Configurations

M/Flex transforms any workspace with unprecedented flexibility and ergonomic performance. Designed for today's agile work environment, users can easily add or remove monitors without disrupting the originally configured installation.

Easy to install and simple to upgrade for an overall reduced cost of ownership, M/Flex is the most scalable solution available for the modern workplace.

M/Flex's modular design makes it simple to reconfigure and allows for independent adjustment of monitors when they are used separately — encouraging flexibility and collaboration at the workstation.

By easily setting monitors at an optimal distance and height, M/Flex increases usable desk space and allows the user to work in a healthy posture throughout the day.



MAXiDESK 68

Triple Monitor Arm, Dock 150 & CPU Holder

MXL-6832VHC-M3DC6

MaxiDesk Wing Shaped Adjustable Height Table, Triple M/Flex M2.1 Monitor Arm; Dock150 (wireless & USB charging pop-up dock, black), CPU-HS600 Holder; 5 wire-management clips, 1 NeatLink horizontal WM, 1 magnetic wire manager cover; Motorized Adjustable Height Base, top finished in high-pressure laminate with 3mm PVC edge trim; footprint of table is 68" x 32".

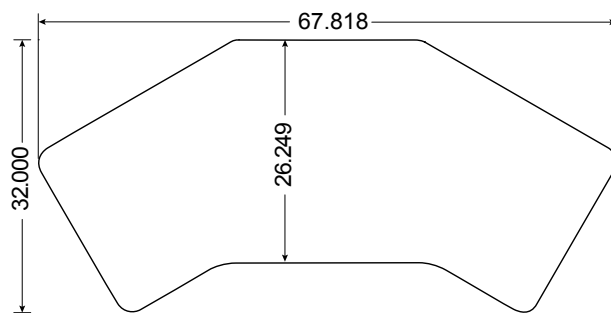

MAXiDESK 51

Double Monitor Arm, Dock 150 & CPU Holder

MXL-5132VHC-M2DG

MaxiDesk Wing Shaped Adjustable Height Table, Double M/Flex M2.1 Monitor Arm; Dock150 (wireless & USB charging pop-up dock, black), CPU-HS600 Holder; 5 wire-management clips, 1 NeatLink horizontal WM, 1 magnetic wire manager cover; Motorized Adjustable Height Base, top finished in high-pressure laminate with 3mm PVC edge trim; footprint of table is 51" x 32".

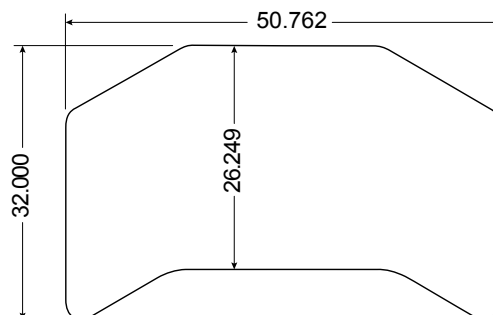

Multi-Use iLid Lift Table

Essential Motorized Standing Desk

Sitting and standing while working is a great way to change up your day, keep active and engaged, and be more productive. This iLid® Monitor Mount gives your experience multi-use flexibility.

Plenty of desktop space with the iLid® in use. All the more utilitarian when closed up like a laptop.

The Essential motorized leg system is robust, made in the USA, and warranted for 2 years.

- Base depth: 22.24"
- Base width: 48"–72"
- Base height: SSE: 27"–46"
- Column dimensions: 3.35" x 2.17"
- Max load: Rated load (including table top): 250 lb. Functional load: 306 lb.
- Top Widths: 42 | 48 | 54

MUL-48VHE-SOW



Quark®

Sit or Stand | Mobile | Laptop | BYOD

The Quark Mobile Laptop Computer Table lets you group members together, work independently, present to a group, work standing up for a change in perspective, work sitting down in comfort.

Quarks dock to form Qstar5 collaborative conference tables.

The Qstar, itself, is available in a fixed height for sitting or standing.

The individual Quark units are height adjustable anywhere within the range.

Top dimension 34" x 34.5"

Variable height range 28" to 36"

May have flipIT Laptop Safe® 18 installed.

QRK | QS5



Conference Table Trough



The Interface G2

Four power and three telecom plate cutouts, available with and without USB to satisfy all your connectivity needs.



Mho

Retractable and durably constructed, Mho is highly functional with a fluid, one touch door that remains open during use.



Interact G2 | UT | Door Optional

Packed with two power, one telecom plate cut-out and two knockouts for keystone inserts.



Oasis Mini

15" trough with 4 power receptacles and 3 Telecom plate cutouts.



Interact 4 G2

4 power on top, 1 convenience receptacle, 2 USB charging, 2 knockouts, lid.



Ellora B

Specify power and USB charging, and AV data ports to customize. 4 or 6 port positions.

Conferencing



Gateway portable HDMI huddle

High definition HDMI audio visual components are packaged neatly inside the unit, and allow for up to 4 users to share ideas on one screen with the simple push of a "Show Me" button.

Vesta Portable Power & Charging

Vesta's portable design can turn almost any space into a collaborative space, providing mobile power where normal outlets fail to reach. Available in a corded version that combines USB-A, USB-C and traditional 110 power, to charge laptops, tablets and mobile phones at the same time. Vesta also comes in a cordless, battery powered version that brings desk height, charging USB perfectly within arm's reach, even outdoors. With Vesta, you can get together, plug in, and get to work – wherever you work.



Ellora

4, 6 or 8 ports for power, USB charger, HDMI, cat 6, Extron Adapter and open data.



Marina

HDMI audio visual components allow for up to 4 users to share ideas on one screen with the simple push of a "Show Me" button.

Surface Mount | Edge mount | Monument | Power Data Charging



Assemble EM

Scales to offer 2, 4 or 5 ports for power, USB charging and data. Edge mounting does not require making cutout for installation. An edgy solution for desktop power and data.



Assemble Reveal

The under desk mounting system presents 2, 4, or 5 ports for power, USB charging and data. Fully retracts when not in use.



Dot® Edge Mount

Cute. Colorful. Fun. Powerful. Mounts to the edge of your desk. Power and USB charging options.



Burele Hole Mount | Edge Mount

This beautiful power and USB charging monument grommet mounts into a hole, or clamps to the edgem offering 4 ports for power, USB charging and data.



Axil X

Scales from 2-8 ports for power, USB charging and data. Edge mounts, presenting outlets horizontally.



Axil Y

A real space saver—scales from 2-8 ports for power, USB charging and data. Edge mounts, presenting outlets vertically.



Seclusion G2

Configurations combine power, USB and USB-C charging, and fully customizable telecom plates. The ideal solution for clamp-on, under-mounted, and desktop applications.



Willow Extension Cord

A single-power simplex with dual-port charging USB and limitless possibilities. With a variety of stylish faceplate colors, sleek wood finish options and cotton braided cords, you're sure to find just the right combination to suit any space.



The Isle™

9 power, 6 USB for Laptops and mobile devices.



The Drifter™

The Drifter's portable design allows it to be easily repositioned.

Conference Table Pop-Up



ComDeck Gas Spring or Electric

Actuated by touch or button, a square section of table top reveals 8 power receptacles and 4 telecom plates for data.



Glenbeigh Contemporary

Available with 2 simplexes or one simplex and one data opening.



Pylon Pull-Up

One electrical outlet rated 15A/120VAC and one Category 5e data insert.



Concept | Square or Round

Simple finger touch reveals power receptacles and data connectors. Each cable management box is 2 sided and spring activated.



Top Notch

Latches in open position: 1 power, one RJ-45.



Nacre

Various configurations of power, data and USB.



The Interface 2

A double-sided unit which provides access to a total of eight power receptacles and eight cutouts for telecom plates.

Grommet Mount



Villa™ AC | USB | RJ45 | Corded or Modular

The Villa™ Power Data Connection Box is mounted below the table surface. Cord pass-through lid is mounted to the top.



Interact G2

Power, data and USB charging accessible at the table top with an additional convenience outlet located underneath for added utility power.



Cove

Cove integrates power, USB charging ports, and data capabilities in any table top. Mounts to surface thicknesses: .75"-1.25"



Dot Z

Choose fun colored simplexes and USB charging duplexes.



Sand Dollar

Designer colors and 2 sizes: 80mm has 2 power and 1 USB duplex; 60mm has either 1 power or 1 USB duplex.



Axil Z

4 ports for power, USB duplexes and data.



HeadQuarters HQ2

Plug in your laptop, use USB to power up your tablet, and wirelessly charge your Qi-enabled device—all at the same time.



Hide-A-Dock

Available 2 power simplexes, or 1 power, 1 USB duplex.



Dean Z

Available in 2, 3, and 5 window units with USB and power, or power simplexes only.



Dock 150 Wireless Charger Pop-Up

Wireless charging and USB charging in a simple package. The pop-up USB ports can be hidden when they are not in use.



Moiré

Power, data and USB configurations include a 2 amp USB duplex that's ideal for charging two tablets and other USB-friendly electronics.



Node

Every workspace deserves a little sparkle. Node's clean, flush mount design presents power and USB charging options you specify.

flipIT® FI Series

flipIT Multi-Use | Tech Storage | Customized to order

The flipIT® has revolutionized the way computer classrooms can be used. This patented flip up monitor mount rotates LCDs into a semi-recessed position—perfect for the user to view the screen and to have unobstructed sight lines in the classroom. Computers can be instantly put away when the teaching method shifts from computer use to lecture, demonstration, or focus on textbooks or mobile devices.

flipIT® Kit US Patent No. 7,509,912

Width :

Single 30 | 36 | 44 | 60 |

Double 60 | 72 | 78 | 88 |

Depth: 26

Height: 28 for keyboard or laptop
30 for keyboard tray models

Laminate with PVC edge trim

SFI DFI



- FI Series: flipIT® Desks contain one of our flipIT kits for LCD monitors or laptops. See page 48 for flipIT® specifications.
- Desks with computer display flipIT® have a CPU bay for each user. Double desks sometimes share one bay.
- Desks with the flipIT Laptop Safe® do not have a CPU bay

flipIT® MetalDesks

Steel base cabinet for flipIT® Workstations

The flipIT® MetalDesk offers a metal base cabinet for those who prefer the look and performance.

Standard Features

- MDF top finished with high-pressure laminate and edged in 2mm PVC
- CPU Rail [dimensions .75" x 1.5" x width] on interior back panel allows CPU Hanger placement anywhere along rail
- Steel base powder coated
- 1.5" diameter heavy duty steel floor leveling glides
- Wire management grommets on sides (80mm)

Width : Single 36 | 42 | 60 |
Double 60 | 66 | 72 |

Depth: 26

Height: 30

SFI-LM DFI-LM

Because the base makes the height 30", only flipIT® with keyboard tray is ergonomically appropriate.



- Options:
- Locks for flipIT® monitor mount systems
 - Locking casters (replace floor glides)
 - CPU Hangers

iLid® Flip-Screen Desks

For PC Computers, AIO, and Touchscreens

As easy to use as opening a laptop. Its friction hinge holds the monitor at any desired angle up to 120°. Includes wire management, CPU storage, and plenty of room for text books. When iLid® is closed, desk converts to a standard desktop—completely computer-free.

Width :

Single 32 | 34 | 36 | 42 | 44 | 60

Double 60 | 64 | 66 | 72

Depth: 28

Height: 30

Laminate with PVC edge trim

SID DID



- Use with VESA compliant LCD monitors
- 26" x 8" keyboard/mouse tray with retaining fence and cord pass-through
- Spacious 10" CPU shelf under desk

The best line of sight of any comparable system!

iLid® MetalDesk

Steel base cabinet for iLid® Workstations

Standard Features

- MDF top finished with high-pressure laminate and edged in 2mm PVC
- CPU Rail [dimensions .75" x 1.5" x width] on interior back panel allows CPU Hanger placement anywhere along rail
- Steel base powder coated
- 1.5" diameter heavy duty steel floor leveling glides
- Wire management grommets on sides (80mm)

Width : Single 36 | 42 | 60 |
Double 60 | 66 | 72 |

Depth: 26

Height: 30

Laminate with PVC edge trim

SID-LM DID-LM



flipIT® Lift Desks

Give your workspace a lift!

Motor-less flipIT® Lift gives silent, responsive control.

No motors to fail and require electricity throughout the space. No whirring for a minute to upset the pace of the communication.

- Supports VESA compatible flat screens and all-in-ones
- Monitor Case Width MAX: 23"
- Screen tilt adjustment
- Two models for monitor weight ranges: 5-15 and 15-24 pounds
- Eleven mounting positions are available to select screen height

Width : Single 36 | 40
Double 66 | 72 |

Depth: 26

Height: 30

Laminate with PVC edge trim

SFL DFL



Available without CPU bays for all-in-ones: 36" and 66" models.

DT Series

Simplicity is its biggest asset.

Sturdy keyboard/mouse trays fully retract so the computer keyboard is out of the way when not in use. The LCD can be on its own stand, giving plenty of room for use with textbooks. Grommets are used for channeling cables to the monitor, but may also be used for grommet mounted LCD arms.

Width:

Single 36 | 44 | 48 | 60 | 72

Instructor Desk, locking storage 60 | 72

Double 66 | 72 Triple 88

Depth: 26 | 30

Height: 30

Laminate with PVC edge trim

SDT IDT DTD



Single desks with double CPU/storage bays are offered for instructors.

iLid® Dual Monitor

Our dual monitor display will make you flip!

Twin screens that fold away, creating a multi-use work space. iLid operates as easily as a laptop, but the scale is two screens wide!

- Maximum monitor size 23" w x 16" h each; 47" total width
- Friction hinge holds monitor at desired angle up to 120 degrees
- One ultra compact keyboard/mouse tray: 28" wide, mousing surface on left and right, 11" track, height adjustable)
- 10" rear shelf under desk for CPU, etc.
- iLid top is black
- 1" levelers
- 60" w x 28" d x 30" h.

Laminate with PVC edge trim

SID-602830-I48



The CPU is housed on a convenient shelf, off of the floor. Wire management is conducted through the base with two 80mm pass-thru grommets and a pair of NeatLinks wire management channels. A power strip provides three 110VAC outlets and 1 USB power for charging devices. Choose laminate top, semi-rigid PVC edge banding and base panels to complement any interior design.

MiraVista® | SubSurface

A great choice for testing and privacy.

Mira Vista means "seeing the big picture." Our downview glass top desk design has been updated with some important features to let you see your wide screen monitor with the clearest view possible. The tempered glass top is not tinted, therefore, you get the maximum brightness and contrast of your LCD.

Keyboard | Mouse Platform 26 x 8

CPU Platform

Robust VESA Mount Arm

Width:

Single 36 | 42

Double 66 | 72

Depth: 30

Height: 30

Laminate with PVC edge trim

SMV DMV



Newpath® flipIT Laptop Safe®

Multi-Use | laptop Security | Constant Power Charging

Newpath Laptop Desks use FlipIT® Laptop Safes for laptop security between sessions—a lockable charging station at the point of use!

When closed, the top surface is usable as a regular study table. Opened, the laptop can be freely positioned for use. The lid profile is even lower than the laptop screen for unobstructed sight lines.

Laptops can remain connected for charging and network updates while stowed. Security tethers may also be added as needed.

Width: Single 30 | 36 | 48

Double 60 | 66

Triple 88 | 96

Height: 29

SNP DNP TNP



flipIT-18 storage space:
16" wide x 11.5" deep x 2.5" thick.

flipIT-23 works with virtually all laptops and PC tablets.

LT Series Laptop Desks

Multi-Use | laptop Security | Constant Power Charging

Laptop Desks have a solid top with your selection of laptop power and USB charging.

Width: Single 30 | 36 | 48

Double 60 | 66

Triple 88 | 96

Height: 28

SLT DLT TLT



iMac® FP Series Desks

SemiRecessed iMac | AIO | Display on its own stand

Now a classroom of iMacs®, All-In-Ones and displays permanently mounted to stands can be used in class without forming walls between teacher and student. Works with 24" monitors.

Offered with open CPU bays for students and locking bay doors for instructors. Choose retractable keyboard trays or work on the desktop with keyboard storage in the well.

Width Single: 36 | 44 | 48

Width Instructor: (locking doors) 60 | 72

Width Double: 66 | 72 | 88

Depth: 26 | 30

Height: 28 keyboard on desktop
30 keyboard tray

Laminate top with PVC edge trim

SFP IFP DFP



Loci™ Study - Testing - Library Carrels

Modular | One-sided | Two-sided | Sit or Stand

Use as testing carrels, library carrels, school study carrels, and laptop carrels. This library furniture features selectable height for sitting or standing, with flipIT® workstations or laptop safes. Endlessly modular— add-on carrels to extend the units to suit floor plan.

Each unit may be set at one of three different heights. Mix or match:

- Laptop height (sitting) 28"
- Keyboard tray height (sitting) 30"
- Standing height 36"

flipIT-19 Workstations or flipIT-18 Laptop Safes may be added as desired. Top shelf may be removed for computer clearance.

Loci Single | Stand-alone | Add-on

Width: 30 | 48 Depth: 28

Height: 28 | 30 | 36 ability

Loci Back-to-Back | Stand-alone | Add-on

Width: 30 | 48 Depth: 56

Work Top Height: 28 | 30 | 36 ability

Carrel Height: 48"



LCS LCA

MacTable

An extension of the iMac® design

MacTables take advantage of Apple Computer's unparalleled industrial design. They allow these amazing All-In-Ones to remain on their permanently fixed stands, yet sunken into the desktop.

The semi-recessed arrangement gives open sight lines in the classroom, so teachers and students can see eye-to-eye, and everywhere else!

Retained in the well, the iMac is protected against being knocked off of the desktop by the casual passer-by. The angles of the legs and modesty panels complement the angles of the iMacs, themselves.

Width

Single 36 | 42

Double 66 | 74

Depth 26

Height 28

SMC | DMC



DL Seminar 202 | 205

Basic technology tables for laptop classrooms

Both styles feature a rectangular top with fold down, removable 10" modesty panel, finished with laminate and PVC trim, modesty panel finished in melamine and PVC trim. Standard 1" diameter levelers, locking carpet casters optional. Included: 6 outlet power strip, 1" x 3" J style wire management channel.

202 Series legs are offset, T shaped, tubular steel with wire management holes, 2" diameter, 14 gauge steel, black nylon bullnose end caps.

IRONS Series legs are offset, T-shaped, steel legs constructed from 14ga tubing; 63.5mm square column, interlocking 30x50mm base tube.

Width 36 | 48 | 60 | 72 | 84

Depth 24 | 30

Height 28

DR202 | DL IRON



202 Leg style, showing wire management holes in one leg. Other wire management options are available, as well as a center T-leg without a modesty panel.



IRONS Leg style, with drop-down modesty panel, showing J-channel wire management and 6-outlet power strip.



IRONS Leg style, table shown with optional power data ports, specified separately.

HorizonLine®

Clear sight lines throughout the classroom!

HorizonLine Computer Tables keep LCD and laptop screens below the horizon line. Students have a clear view of the classroom, the instructor, and their own screen. CPUs, cables, and clutter are organized below the table top.

HorizonLine with flipIT is all about the user interface. Computer systems are accessible and comfortable for a wide range of user body types. Recessed flat screens, below the horizon line, promote unobstructed sight lines in the computer classroom. CPUs are off the desktop and out of the knee space. Keyboards are presented at 28 inches—the ergonomic standard for a range of adult users. Wire management reduces clutter and keeps systems organized. Optional power and data ports offer additional top-side connectivity for any application you desire.

Width

Single 36 | 44 | 52 | 60

Double 60 | 66 | 72

Triple 88 | 96 | 100

Depth 26

Height

28 for laptops/keyboards on the table surface

30 for keyboard trays

SHL | DHL | THL

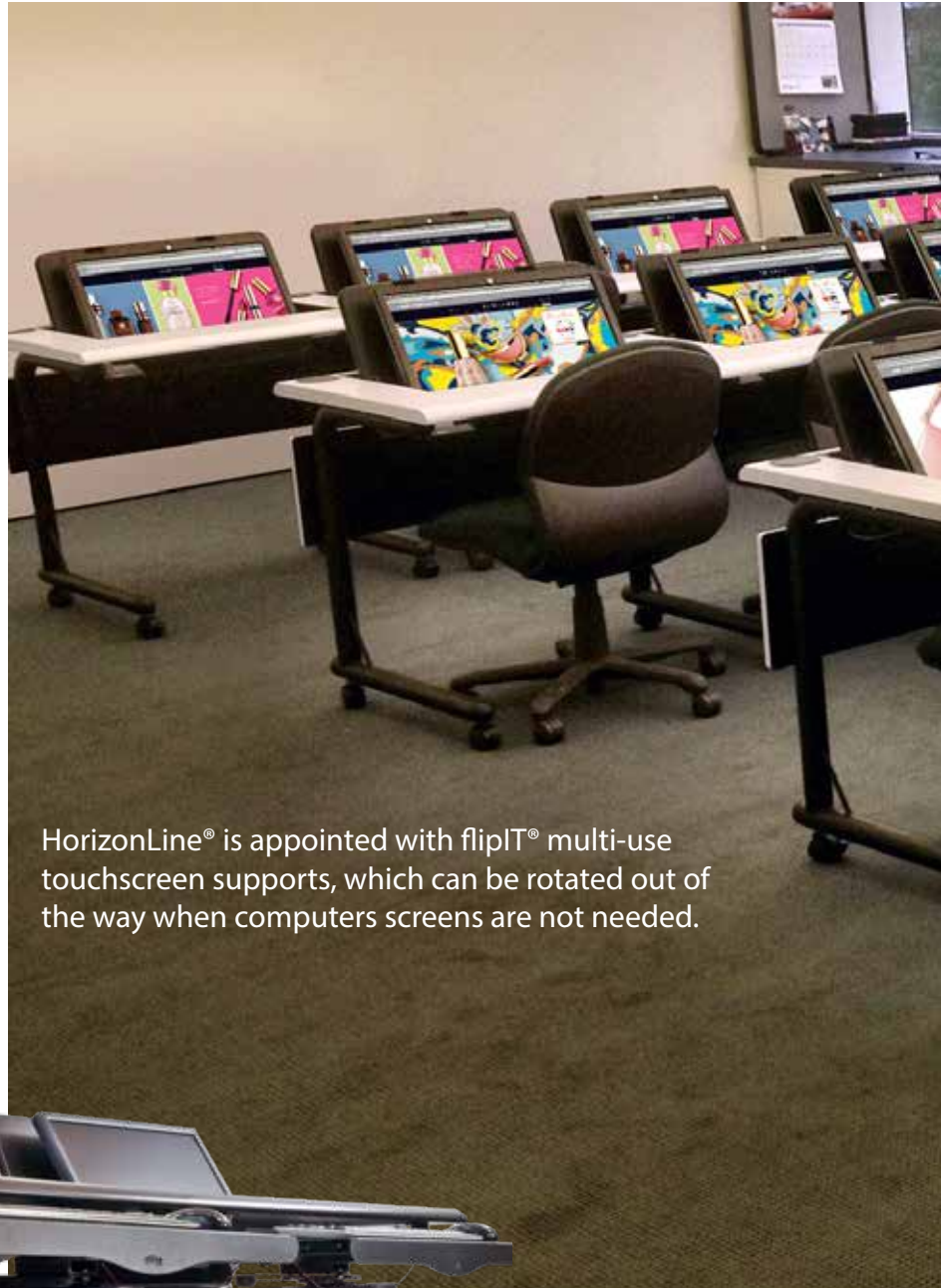

HorizonLine® is appointed with flipIT® multi-use touchscreen supports, which can be rotated out of the way when computers screens are not needed.



Look below the surface to find the real beauty of HorizonLine® Computer and Laptop Tables! The C-legs keep out of the knee space. The optional bracket for hanging a CPU holder is out of the knee space. The 12 AMP 6-outlet power strip, standard equipment, has a 10 foot cord for running power easily from table to table. The J-channel has enough capacity to take care of the cable clutter!



Single and double user HorizonLine Tables are used to make modular conference tables of different sizes. Multi-use space is made possible by flipIT Laptop Safe, which can instantly close and lock laptops away when not needed.



iLid® Computer Tables

Touchscreens, All-In-Ones and PCs

Operating with the ease of a laptop, iLid lets the computer come into play or get out of the way, as appropriate for the lesson plan. Lift the iLid, and find the screen angle that's best. The friction fitting hinge lets you place the screen angle where you want it. When it's time to stow the computer, the keyboard and mouse are placed on the storage tray. Just close the lid, and the computer is put away.

Designed for heavy institutional use. Dimensioned for classroom comfort with optimum numbers of students placed in the room.

Width

Single 36

Double 72

Triple 96 | 100

Depth 26

Height 29 with keyboard storage

30 with keyboard tray

SIT | DIT | TIT

Generous space for keyboard and use of printed materials. The semi-recessed monitor position promotes interaction with unobstructed sight lines.



Finish choices are high pressure laminate with PVC edge or 3D thermofoil over contoured self edges.

A retractable keyboard tray may be specified instead of the keyboard storage tray.



The iLid® Keyboard Storage Shelf is located for easy access. Open the iLid® as you would a laptop, then reach inside the opening to retrieve the keyboard and mouse. When stored, the angled shelf is out of the knee space, as is the CPU, which suspends in line with the footprint of the leg. A very efficient use of space for comfortable use.





Nesta™ Flip Top Tables

Easy Storage | Easy Setup | Modular Power Wiring

Nesta™ Laptop Tables simply plug together. They fold up for easy access to cables, for easy transport through doorways and efficient storage. They fold down for roomy support of laptops in the classroom.

The structure is robust, built to stand up to physically demanding, institutional use. Perfect for spaces that need to quickly change functions, or for laptop classrooms that need to move to different spaces.

UL certified modular power is a quick connect system for fast set-up and mobility.

Nesta™ is available with other top connection boxes to suit.

Width: 36 | 48 | 60 | 66 | 72

Depth: 24 | 26 | 30

NSL | NSU





Villa™ Power & Data Ports are made for the DaisyLink™ modular wiring system. Plug and play power is UL and CUL listed. Each Villa™ serves two users with data and power. Flush lid design with brush trim. Brushed aluminum finish.

DaisyLink™ Modular Wiring conducts power from your installed wall outlet to a row of tables. Room layout drives electrical service specifications. We collaborate to deliver an engineered, plug & play solution



Pi™ Tables

Enter the circle of collaboration

Collaboration is a circle. Relationship is the perpetual constant in a collaborative environment. Pi is the constant relationship for calculating not only the area of a circle, but also, the area for collaboration!. Built on the geometry of circles, not rectangles, Pi™ nest together. This unlocks infinite possibilities for team computing groups.

Top finished in wood-grain or color 3D scratch resistant thermofoil with matching 10" modesty panel.

NeatLinks wire management channel and power strip mount to the modesty panel. Leg mounted EZcinch CPU holder may be specified for PC configuration.

Overall Dimensions:
42"W x 26"D x 28" or 30" H

PIL | PIR

The concave side defines the "right" or "left" based on the users point of view. A power data service port may be installed to suit. Also offered with flipIT® 19 or flipIT Laptop Safe® 18. Casters are optional. Working height is 28"; 30" when keyboard tray is used.

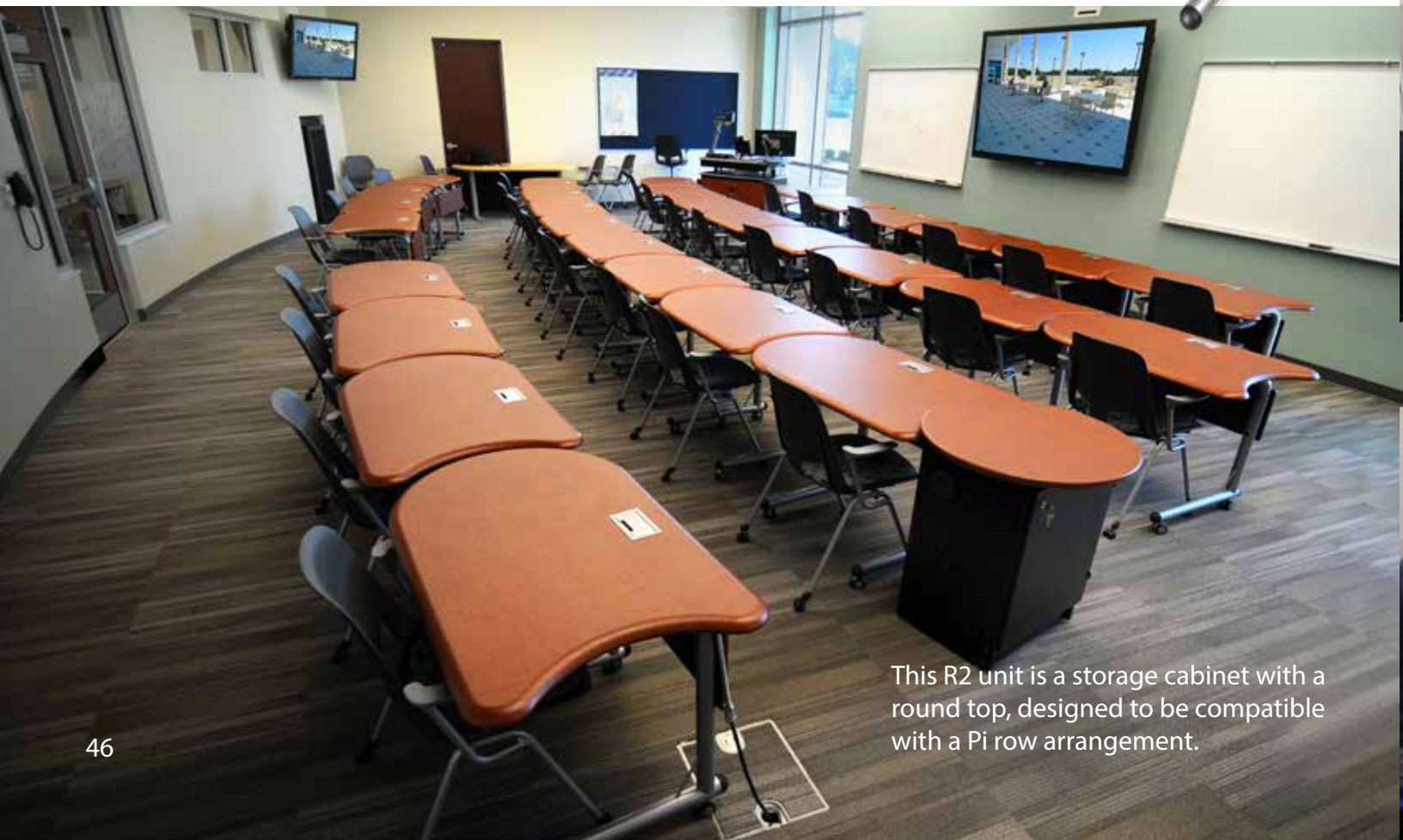

This R2 unit is a storage cabinet with a round top, designed to be compatible with a Pi row arrangement.



Pi tables are especially good for long curve, auditorium style arrangements. The universal joint allows any angle within its range.



Pi Tables can be pushed together head-to-head for small group collaboration. The flipIT Laptop Safe® permits multi-use of the work surface. Laptops stay connected to power for continuous charging at the point of use. Battery life is not a delay factor.

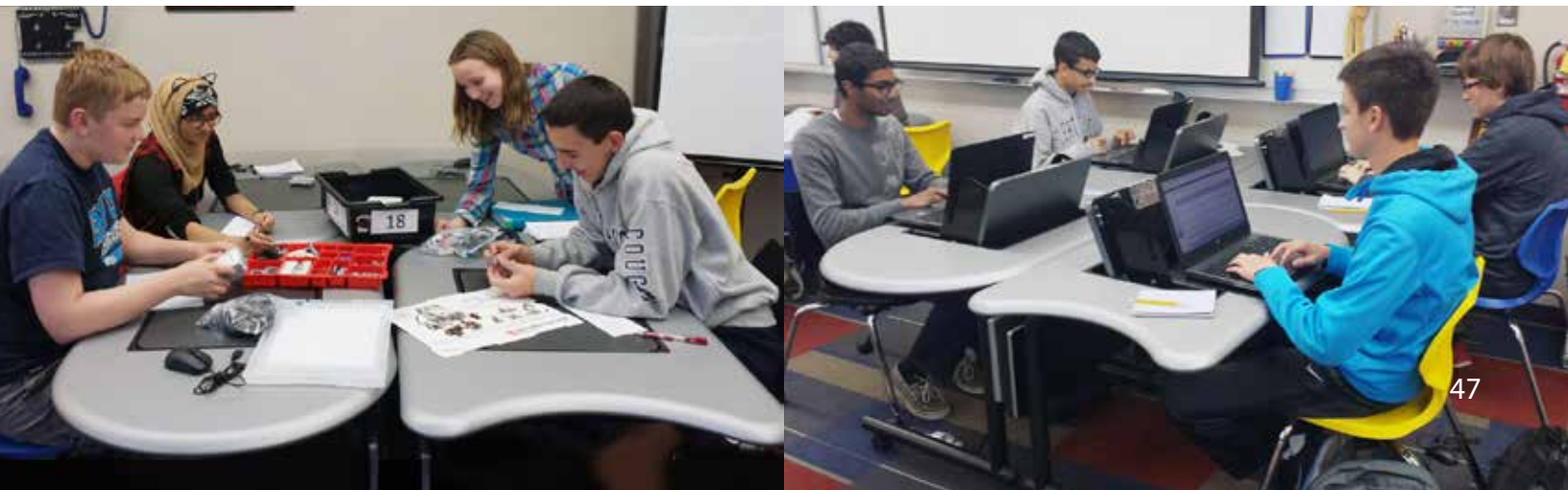

TriO Tables

The Power of 3— Exponential Flexibility

TriO's three table top sections suggest groupings for team work, but also imply privacy in the context of a digital commons area. This encourages focus and engagement, with flexibility—the watch word in project-based learning.

Technology users can power up from six power outlets and 6 USB power outlets. Additional technology can be stored in the center column with convenient cable management. AV technology stored in the console may be accessed from locking vented doors in the base, or from the hinged top.

TRIO
TriO Station

60" dia. 3 power, 6 USB charging

72" dia. 3 power, 6 USB charging

84" dia. 6 power, 6 USB charging



TriO Power Console

- Triangular center console with lift-up top and wire management access openings
- Center console finished with high pressure laminate and semi-rigid PVC edge trim
- Sides of center console finished in melamine with edge trim
- Shelf inside the console has wire management opening
- 3 (three) 12" wire wonders for cable management, black
- Center console sides vary with table size
- Height of center console is 33"
- Power Convenience Outlets: 3 (three) Cove units, black, each with 1 power receptacle (120 VAC, spill resistant) 2 USB charging ports (2.1A, 11W, 5V/DC) and 108" power cord



- 84" table has 3 Cove with 2 power, 2 USB charging each



Active Learning Furniture

A different SKool of thought.

The arrangement of students in active learning environments just got easier and more fun.

SKool Tables nest together to promote the flow of communication.

The arrangements can be in a line, in a grid, in arcs—in circles of 4, 5, 6... the possibilities are endless.

The tops are 30mm MDF finished in your choice of designer high pressure laminate (HPL) with semi-rigid PVC edge trim that hugs every contour.

The fixed height tubular steel T-legs are available with locking carpet casters—2" diameter 14 gauge steel column and main bar with black nylon bullnose end caps.

The square-column, height adjustable ratchet legs have variable height adjustment with 12 stop positions. Base height range: 9.45" (from 28" to 37.45").

- A grommet may be added to serve cables.
- Wire management modesty panels are also an option.
- Dimensions are 42w x 28d x 28h for the fixed height tables; the variable height range is 28 - 37.45
- Consult with us about adding power and data connection boxes that are configured for your technology requirements.



Active Learning

Ethos Storage Base

More than a chair, Ethos doubles as an active learning platform for twenty-first century pedagogy. An agile quad base plus classic seat shell, Ethos blends flexibility (like 360-degree swiveling capability and an ambidextrous tablet arm) with mobility and personal storage. Haskell's seating design anticipates the needs of today's vibrant classroom, a classroom that transitions seamlessly from lectures to discussions and interactive groups.

Available with or without tablet arm



Tablet | Arm | Stool

Ethos 5star

The Ethos seat is available with 5-star base, with and without tablet arm. The stool base is height adjustable.



Nesting | Team

Relay Series

Relay provides lasting comfort in a stylish design that makes an appealing multi-purpose seating option for meeting, training, conference and break rooms.

The seat and back are molded from high-impact thermoplastic for lasting durability and comfort. Add the optional upholstered seat and back for a more sophisticated, inviting look and added comfort.



Genesis Team Seating

Open storage area under seat
22" x 18" x 10" or storage drawer

Matching arm caps, tablet arm
and shelf

16.5" x 10.75" tablet arm supports
up to 15 lb. evenly distributed.

Seat: 21"W x 20"D x 18.5"H



Active Office

3dee® Motion

The 3Dee Active-Office-Chair is the first of its kind.

Its 3D movement is designed to deliver more well being, more energy, more balance, but most of all more motion.

- seat width – 18.1" seat depth – 18.1"
- back width – 17" back height – 16.9"
- height range – basic spring – 16.5" – 22"
- base diameter – 29.5"
- chair weight capacity – 290lbs
- chair weight – 44lbs
- overall chair height – 43.3" (includes backrest)
- casters – universal locking safety casters
- upholstery – microfiber fabric



Sit | Stand Stool

muv•man® Active Sit Stand

The true sit-to-stand seating solution. The center post offers lateral motion and a thirteen inch height adjustment range. This low impact, subtle, intuitive motion makes sitting and standing healthy, dynamic and fun.

The muvman® stool is tilted forward. This means you can always be at an optimum distance to your working surface regardless of your height and physique.

The muvman® is an intelligent seat that gives you proper support without causing pressure points. With lots of practical details, such as the grip for easy carrying of the seat, the muvman® stool is the ideal ergonomic office chair. The sleek look for muvman®, a design that has won national and international awards, rivals any modern office chairs.



Executive | Task Seating

Freedom Task

The Freedom chair features weight-sensitive recline and synchronously adjustable armrests to keep the sitter exceptionally comfortable while also lowering the risk of long-term injury.

- Intelligent counterbalance recline mechanism automatically provides the right amount of support through the full range of recline motion, regardless of user size and weight
- Extra motion of the backrest during recline automatically adjusts to the changing needs of the spine
- Adjust the arms with just one hand
- Sculpted cushions closely follow body contours, which increase contact and decreases concentrated loads



Liberty Executive

SELF-ADJUSTING RECLINE

Intelligent counter-balance recline mechanism automatically provides the right amount of support through the full range of recline motion, regardless of user size and weight

- No tension springs to adjust
- No recline locks to set/release
- During recline, the angle between torso and legs opens up for better body function
- User maintains near constant eye level during recline

PIVOTING BACKREST

- Extra motion of the backrest during recline automatically adjusts to the changing needs of the spine.
- Provides additional lumbar support as needed

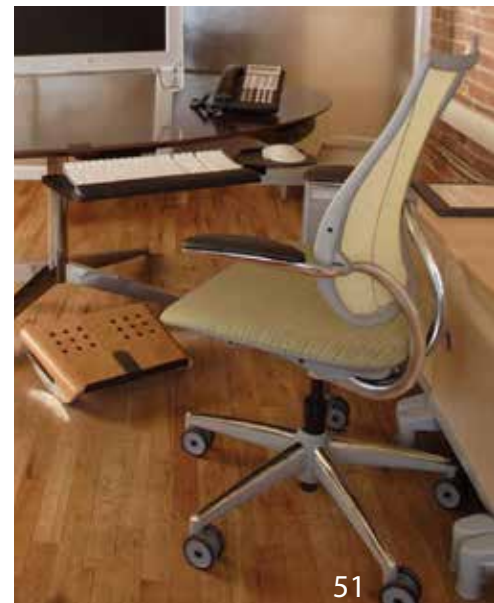

Executive Conference

Amplify Upholstered Highback

This upholstered highback introduces Dynamic Lumbar, a patent-pending integrated adjustable lumbar positioned within the padding for matchless comfort and maximum ergonomics.

The thin back conceals the mechanism that delivers 3.75" of lumbar support, with two symmetrical sliders the only visible indication of the superb ergonomics that lie within. Lumbar adjustment can be accomplished while seated.

Amplify highback upholstered is available in thousands of textiles, from fabric/vinyl grade 1 to leather grade 5.

The durable polyurethane back/back support is available in black and fog, with an eye-catching fog/silver

option to match silver arms and base. A polished aluminum base is an option.



Highback | Midback | Stool

Wit Task Seating

Efficient and ergonomic, Wit midback and highback chairs have evolved through equal portions of design, comfort and value to be keenly suited for task, conference and collaboration settings.

Wit delivers an upscale designer look in multiple colors without compromising strength and durability. Wit and its major components are designed to meet and exceed ANSI/BIFMA standards.

The Wit chair outshines bulkier higher-priced chairs with great design and its array of ergonomic standard features, but it also surpasses expectations with mobility, youthful simplicity and highly evolved strength and durability.



Nesting | Tablet Arm | Cafe | Task | Side | Stool

InFlex Multi-Purpose Stacking Chair

Contemporary styling and spine-friendly comfort – at an affordable price. Versatile InFlex comes in both plastic stacking side models and upholstered side, task, and stool versions. The contemporary styling emulates the human spine. Its innovative flex-back disc system, with 13 degrees of back angle range, is as clever as it is comfortable.



Nesting | Tablet Arm

Rio—Active Rebound Control

Rio features ARC Technology® (Active Rebound Control) to achieve weight-assisted flex.

RIO MODELS:

- 4-leg stacking side chair
- NEW! Wire rod stacking side chair
- 4-leg 24" counter or 30" bar stools
- Light task chair
- Light task stools (standard, extended stool kit)



Wire Rod Chair



4-Leg Chair with Fixed Arms and Casters



24" Counter Stool



30" Bar Stool with Fixed Arms



Light Task Chair



Task Stool

All Day Nesters

Movi

Meet the last nester you'll ever need. Whether you're setting up, breaking down or making space for spontaneous collaboration, today's modern workplace calls for high-design seating solutions that can keep up with it all. Enter Movi: our lightweight flexing nester with a slim, modern frame and extra flexibility built right in for comfort all day long.



Executive | Task Seating

Focus

Discover comfort so remarkable it's actually unremarkable. As in, you can finally stop (re)adjusting your seat—and get some work done. We designed the extra-roomy seat cushion from molded foam and added an extra layer of thickness for a firm yet plush feel. The sloped, waterfall edge helps promote proper circulation so you can sit for longer periods. Productivity, here you come.



CPU Holders



EZ Cinch™

Strap any size CPU, large or small, to suspend your CPU in the negative space of our leg systems for HorizonLine™, Pi™ and MacTable™.

CPU-EZC



The Li'l Brig™

The Li'l Brig CPU Holder gives you easy access to drives and cable connections, and the security to keep the CPU where it belongs: behind bars!

CPU-LBG



CPU600

Designed for standard towers, mounts directly to table bottom for designerly asset security. Fits cases 3.6 - 10" w x 12-20" h.

CPU600



CPU200

Small form factor CPU holder mounts directly to table bottom. Fits cases 1 - 5" w x 6-12" h.

CPU200

LCD Arms



M8 Dual Monitor Arm

Crossbar (holds two monitors), includes VESA adapter (75mm & 100mm); height adjusts 11.5", up to 22" depth adjustment.

MS-M8 Single M8 also available.



M2 Single Monitor Arm

Uses a mechanical spring to achieve exceptional performance and durability in a lightweight, ultra-thin design. Arm reach: 20". Height adjustment range: 10"

MS-M2



M/Connect™ Docking Station

Works with M2, M8, and M/Flex monitor arms, M/Connect gives easy access to user ports and conceals IT ports to eliminate cable clutter.

MS-MCON



M/Flex M2.1 Monitor Supports

M/Flex transforms any workspace with unprecedented flexibility and ergonomic performance. Users can easily add or remove monitors without disrupting the originally configured installation.

MS-M2.1

Keyboard Trays



ZeroPoint™

The ZeroPoint Articulating Keyboard Tray is designed to ensure that users type and mouse within their Neutral Reach Zone. Platform Tilt Adjustment: 0 to -10°. Height adjustment range: 5 1/4".

KBD-ZPT

54



Dual Arm 26x8

Keyboard/Mouse Tray; 26" x 8", steel powder coated in black, full extension platform using Accuride 12" steel roller bearings.

KBD-26X8



Ultra Compact

Patented "No Knob / Gravity Lock" spring assisted height adjustment. 5-3/4" total height adjustment range [1-3/4" above; 4" below the worksurface]

KBD-UC

Desktop Dividers

Enclave Privacy Panels

Choose frosted acrylic with smooth edges or fabric panel with rounded corners, edge-banded in silver, core is 3/4" thick acoustic absorbing material. Temporary and permanent mounting possible.

Multiple sizes and mounting options for easy attachment to any style table, and easily integrated with SMARTdesks furniture.

Width: 17" | 23" | 29" | 36" | 48" | 60" | 72"

Height: 18" | 22"

PPFAD



Workspace Partitions

Dual Panel 3x Series

Feet or Casters are ordered separately

Aluminum frame powder coated in pewter silver; desk height divider is 31 1/4" from the floor, frame is 1.2" wide. Feet or Casters are ordered separately.

Upper Panel Choices:

Frosted Acrylic or Tackable Fabric

Lower Panel: Tackable Fabric

Heights: (without feet or casters)

48" | 62" | 72"

Width: 49" | 61" | 73"

PP3X



Mobile Whiteboards

SMARTscreens™

SMARTscreens Mobile Marker Boards

Engineered to be durable, light weight and easy to move. Whiteboard surfaces are non-ghosting and designed for high usage. Perfect for conference rooms, school classrooms, training rooms, meeting rooms, private offices, and at workstations as a portable privacy partition or a rolling cubical door.

Core for bottom panel: Tackable Fabric

Accessory rail is 23-1/2" from the floor

Only the top panel changes in height: the bottom panel always stays the same height

Width: 49" | 61" | 73" Height: 54" | 62" | 72"

Base Options: Feet and casters, may be used together or in combination.

PP-3SL4



flipIT® Monitor Mount

Ergonomic | Multi-Use | Unobstructed Sight Lines

The Original SMARTdesks® introduced flipIT® to conference tables and classrooms so people could use computers with the ease of using a laptop. It caught on. The screens are lower than the horizon line for unobstructed sight lines and greater interaction. Available with and without keyboard tray. Optional lock. Sized for 20" or 24" VESA compatible displays. Sold as a kit for retrofitting conventional desktops.

FIK-19 | FIH-19 | FIK-23 | FIH-23

US Patent No. 7,509,912

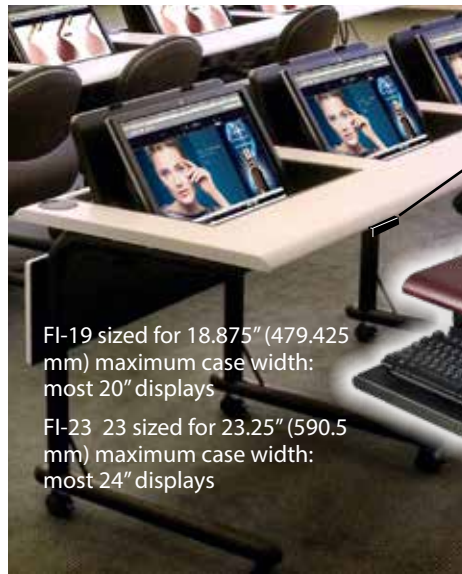

FIH models have a handle to actuate the flipIT® opening. FIH-23 shown.

FI-19 sized for 18.875" (479.425 mm) maximum case width: most 20" displays

FI-23 23 sized for 23.25" (590.5 mm) maximum case width: most 24" displays



flipIT Laptop Safe®

Ergonomic | Multi-Use | Unobstructed Sight Lines

Provides safe haven for laptops, protecting them from drops and damage. Connected to power even when closed, dead batteries won't delay lesson planning. Positive latch lock keeps flipIT® closed for easy desktop use. Opens with the pull of a handle and tray. FIL-18 is sized for smaller desktops. Capacity 16" wide x 4.625" deep x 2.5" thick. FIL-23 is wider: 22.25".

FIL-18 | FIL-23

US Patent No. 7,509,912



flipITlift®

No Motors | Full Adjustability | Multi-Use Desktop

Opens and closes smoothly and silently, flipIT® monitor lift uses no counterweights or spring adjustments. Supports VESA compatible flat screens and all-in-ones.

The total height stored is 27.3".

Travel distance: 20"

Eleven mounting positions are available to select screen height.

MS-FLIFT-TLG for monitors 5-15 lbs

MS-FLIFT-THG for monitors 15-24 lbs



Screen tilt adjustment.
Stows in vertical position.

Table top cutout: 7.875" x 23.875" | Maximum case width for monitor: 23"



Furniture & Floor Integration Technology

Design the power & data distribution for your technology-based classroom along with the SMARTdesks® technology furniture.

If you decide to change your floor plan later, we make it easy. Simply pick up the 50cm carpeted section with the outlets, place it where you want it, then bury cabling back. No special tools or labor required.



FFITfloor®

Installation takes a day

The carpeted FFITfloor® units arrive ready to place. The ramp and rail system is made to order for the space to meet ADA requirements. UL outlets simply snap together by installers.

Your electrician installs the whip into the facility power panel whenever it is convenient. Your IT specialist oversees the placement of data cables.

One stop, turnkey solution: FFIT
Furniture + Floor Integrated Together

800 770 7042 | www.smartdesks.com

SMARTDESKS®

where design meets technologysm

The logo for SmartDesks, featuring the word "SMARTDESKS" in a stylized blue and black font, enclosed in a white rounded rectangle.

SMARTDESKS®

where design meets technologysm

GSA Contract Holder

PEPPM
COOPERATIVE PURCHASING

TX MAS



800 770 7042 | www.smartdesks.com

Front Cover: USPS National Training Center, Washington, DC
Back Cover: University of Maryland, Salisbury Community College, Salisbury, MD

Catalog 2019-20